

AD·INOX

Mislite zeleno,
Budite učinkoviti

Think green,
Be efficient

KATALOG NAPA • HOOD CATALOGUE

AD · INOX

TOČKASTO ZAVARENE NAPE

SPOT WELDED HOODS

SNACK ZIDNE NAPE	05
SNACK WALL HOODS	
Snack zidna napa bez motora	06
Snack wall hood without extractor fan	
ZIDNE NAPE	08
WALL HOODS	
Klasična zidna napa bez ventilatora	09
Classic wall hood without extractor fan	
Tanka zidna napa bez moora	12
Slim wall hood without extractor fan	
CENTRALNE NAPE	15
ISLAND HOODS	
Centralne nape EC-S snack	16
Island hoods EC-S snack	
Centralne nape bez linijskog ventilatora	18
Island hoods without line extractor fan	

POTPUNO ZAVARENE NAPE

WELDED HOODS

ZIDNE NAPE GABBIANO LINE	22
WALL HOODS GABBIANO LINE	
Gabbiano line zidne nape	23
Gabbiano line wall hoods	
CENTRALNE NAPE GABBIANO LINE	26
ISLAND HOODS GABBIANO LINE	
Centralne nape g abbiano line bez motora	27
Gabbiano line island hoods without extractor fan	
PRAVOKUTNE ZIDNE NAPE	29
CUBIC WALL HOODS	
Pravokutne zidne nape	30
Wall hoods kubik line	
PRAVOKUTNE CENTRALNE NAPE	32
CUBIC ISLAND HOODS	
Pravokutne centralne nape	33
Wall hood kubik line without fans	
KOMPENZACIJSKE NAPE (EKO)	35
COMPENSATION HOODS	
Zidna kompenzacijska napa KPR linija	36
Wall compensation hood KPR line	
Centralna kompenzacijska napa KCR linija	38
Island compensation hood KCR line	
Zidna kompenzacijska napa KCR-D linija	40
Wall compensation hood KCR-D line	

PRIRUČNIK ZA ASPIRACIJU
ASPIRATION MANUAL

42

TOČKASTO ZAVARENE NAPE

SPOT WELDED HOODS

Točkasto zavareni nehrđajući čelik (AISI 304 ili 430 ovisno o modelu) sa Scotch-Brite brušenim završetkom. Svi metalni rubovi su zaobljeni, čak i u unutarnjim dijelovima. Odvodna slavina i obodni kanal za skupljanje kondenzata, 1/2", labirint filteri. Tamo gdje je uključen, odsisni ventilator je s regulirajućim monofaznim motorom. u Navedene dimenzije nisu obvezujuće. Svaki model ima mogućnost prilagođavanja prema potrebama kupca.

Spot-welded stainless steel (AISI 304 or 430 depending on the model) with Scotch-Brite satin finish. All metal edges are turned in for rounded finish, even in inside parts. Drain cock and perimetric canal for condensate collection, 1/2" . Baffle filters. Where included extractor fan with adjustable mono-phase motor. Capacitor and box terminal board in IP 55. The dimensions listed are not binding. Each model has the possibility to be customized according to the customer's needs.

SNACK ZIDNE NAPE

SNACK WALL HOODS

Nape ove serije dizajnirane su i proizvedene za postavljanje na različite blokove za kuhanje čak i s niskim stropovima. U potpunosti izrađen od nehrđajućeg čelika (AISI 304 ili 430 ovisno o modelu) sa scotch brite završnom obradom. Sastavljeno točkastim zavarivanjem spojeva, s rubovima presavijenim čak i u unutarnjim dijelovima. Perimetralni kanal za sakupljanje kondenzata s odvodom od 1/2", labirint filteri od nehrđajućeg čelika. Ovisno o modelu, nape ove serije mogu biti opremljen integriranim osvjetljenjem i regulatorom brzine.

The hoods of this series have been designed and manufactured to be positioned on different cooking blocks even with low ceilings. Entirely made in stainless steel (AISI 304 or 430 depending on the model) with scotch brite finish. Assembled by spot-welding of the joints, with edges folded even in the internal parts. Condensate collection perimeter duct with 1/2" drain tap. Labyrinth filters in stainless steel. Depending on the model, the hoods of this series can be equipped with integrated lighting and speed regulator.

SNACK ZIDNA NAPA BEZ MOTORA

Serie 70 / 90 / 110

SNACK WALL HOOD
WITHOUT EXTRACTOR FAN

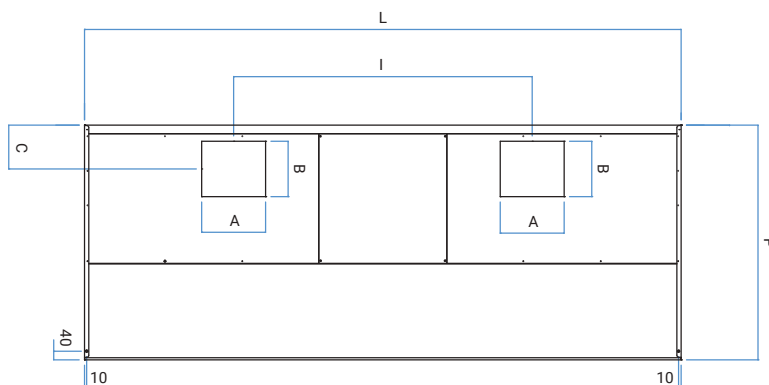
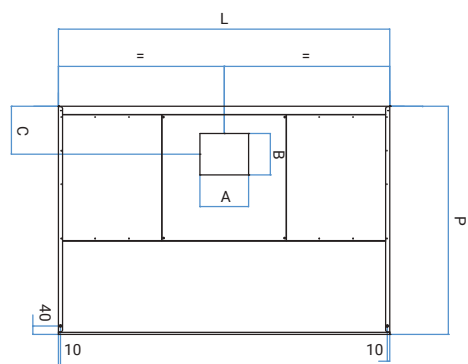
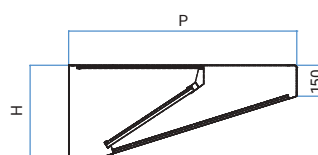

Serie 70

Modeli Models	304 €	Modeli Models	430 €	Dim. PxLxh mm	AxB mm	C mm	D mm	Filteri n° Filters n°	Težina Kg Weight Kg	Vol. MC/H*	I mm	LED €
ES 7/10	605,50	43S 7/10	518,00	700x1000x450	230x200	230	140	2a	26	900		143,50
ES 7/12	667,80	43S 7/12	571,20	700x1200x450	230x200	230	140	2b	30	1100		145,60
ES 7/14	735,70	43S 7/14	628,60	700x1400x450	230x200	230	140	2b	34	1250		214,90
ES 7/16	792,40	43S 7/16	678,70	700x1600x450	230x200	230	140	3a	37	1400		216,30
ES 7/18	869,40	43S 7/18	742,00	700x1800x450	230x200	230	140	3b	40	1600		300,30
ES 7/20	942,90	43S 7/20	804,30	700x2000x450	300x260	210	140	4a	44	1800		303,80
ES 7/22	997,50	43S 7/22	851,90	700x2200x450	300x260	210	140	4a	46	1950		308,00
ES 7/24	1.066,80	43S 7/24	910,70	700x2400x450	300x260	210	140	4b	48	2200		338,10
ES 7/26	1.152,90	43S 7/26	984,20	700x2600x450	300x260	210	140	4b	51	2300		341,60
ES 7/28	1.223,60	43S 7/28	1.044,40	700x2800x450	230x200x2	230	140	5b	54	2500	1400	343,00
ES 7/30	1.290,10	43S 7/30	1.101,80	700x3000x450	230x200x2	230	140	5b	57	2700	1500	345,80
ES 7/32	1.360,10	43S 7/32	1.160,60	700x3200x450	230x200x2	230	140	5b	61	2800	1600	460,60
ES 7/34	1.473,50	43S 7/34	1.257,90	700x3400x450	300x260x2	210	140	6b	64	3000	1700	462,00
ES 7/36	1.541,40	43S 7/36	1.315,30	700x3600x450	300x260x2	210	140	6b	67	3200	1800	464,10
ES 7/38	2.113,72	43S 7/38	1.409,10	700x3800x450	300x260x2	210	140	6b	71	3350	1900	466,90

KONSTRUKCIJSKE KARAKTERISTIKE:

Poseban profil čini ga idealnim za različite zidne blokove za kuhanje, čak i s niskim stropovima. Izrada od AISI 304 ili AISI 430. Posebna izrada na zahtjev.

ISPORUČENO:

- Labirint filtri
- Slavina za ispuštanje kondenzata 1/2"
- Ostale duljine

BILJEŠKE:

Za pribor pogledajte odgovarajuće stranice. Pakiranje u stretch foliju

Serie 90

Modeli Models	304 €	Modeli Models	430 €	Dim. PxLxh mm	AxB mm	C mm	D mm	Filteri n° Filters n°	Težina Kg Weight Kg	Vol. MC/H*	I mm	LED €
ES 9/10	662,20	43S 9/10	565,60	900x1000x450	230x200	230	140	2a	26	1100		159,60
ES 9/12	707,00	43S 9/12	604,80	900x1200x450	230x200	230	140	2b	30	1400		163,10
ES 9/14	777,70	43S 9/14	664,30	900x1400x450	230x200	230	140	2b	34	1650		231,00
ES 9/16	837,20	43S 9/16	714,70	900x1600x450	230x200	210	140	3a	37	1400		233,80
ES 9/18	930,30	43S 9/18	795,20	900x1800x450	230x200	210	140	3b	40	2000		317,10
ES 9/20	986,30	43S 9/20	843,50	900x2000x450	300x260	210	140	4a	44	2250		319,20
ES 9/22	1.084,30	43S 9/22	925,40	900x2200x450	300x260	210	140	4a	46	2500		324,80
ES 9/24	1.124,90	43S 9/24	960,40	900x2400x450	300x260	210	140	4b	48	2700		354,20
ES 9/26	1.213,10	43S 9/26	1.034,60	900x2600x450	300x260	210	140	4b	51	2950	1300	357,70
ES 9/28	1.290,10	43S 9/28	1.074,80	900x2800x450	230x200x2	210	140	5b	54	3200	1400	359,80
ES 9/30	1.355,90	43S 9/30	1.157,10	900x3000x450	230x200x2	210	140	5b	57	3400	1500	361,90
ES 9/32	1.428,70	43S 9/32	1.220,10	900x3200x450	230x200x2	210	140	5b	61	3650	1600	476,00
ES 9/34	1.552,60	43S 9/34	1.324,40	900x3400x450	300x260x2	210	140	6b	64	3850	1700	478,80
ES 9/36	1.650,50	43S 9/36	1.409,10	900x3600x450	300x260x2	210	140	6b	67	4050	1800	480,20
ES 9/38	1.774,50	43S 9/38	1.514,10	900x3800x450	300x260x2	210	140	6b	71	4300	1900	483,00

CONSTRUCTION CHARACTERISTICS:

The special profile makes it ideal for different wall cooking blocks, even with low ceilings. Construction in AISI 304 or AISI 430. Special fabrication on request.

SUPPLIED:

- Baffle filters
- Condensate draining cock 1/2"
- Other lengths

NOTES:

For the accessories please see the relative pages. Pluriball wrap packaging with polystyrene corners included.

Serie 110

Modeli Models	304 €	Modeli Models	430 €	Dim. PxLxh mm	AxB mm	C mm	D mm	Filteri n° Filters n°	Težina Kg Weight Kg	Vol. MC/H*	I mm	LED €
ES 11/10	733,60	43S 11/10	627,20	1100x1000x450	230x200	230	140	2c	35	1400		175,70
ES 11/12	770,70	43S 11/12	658,70	1100x1200x450	300x260	210	140	2d	38	1700		178,50
ES 11/14	850,50	43S 11/14	725,20	1100x1400x450	300x260	210	140	2d	41	1950		247,80
ES 11/16	900,90	43S 11/16	770,00	1100x1600x450	300x260	210	140	3c	44	2200		249,90
ES 11/18	991,90	43S 11/18	846,30	1100x1800x450	300x260	210	140	3d	47	2500		333,90
ES 11/20	1.063,30	43S 11/20	907,20	1100x2000x450	300x260	210	140	4c	50	2800		336,00
ES 11/22	1.122,10	43S 11/22	957,60	1100x2200x450	300x260	210	140	4c	53	3100		341,60
ES 11/24	1.166,90	43S 11/24	995,40	1100x2400x450	300x260x2	210	140	4d	56	3400	1200	371,70
ES 11/26	1.255,80	43S 11/26	1.071,70	1100x2600x450	300x260x2	210	140	4d	59	3600	1300	373,10
ES 11/28	1.364,30	43S 11/28	1.164,80	1100x2800x450	230x200x2	210	140	5d	62	3900	1400	376,60
ES 11/30	1.452,50	43S 11/30	1.239,00	1100x3000x450	230x200x2	210	140	5d	65	4200	1500	378,70
ES 11/32	1.570,10	43S 11/32	1.339,10	1100x3200x450	230x200x2	210	140	5d	68	4500	1600	492,10
ES 11/34	1.661,10	43S 11/34	1.417,50	1100x3400x450	300x260x2	210	140	6d	73	4700	1700	494,20
ES 11/36	1.762,60	43S 11/36	1.505,00	1100x3600x450	300x260x2	210	140	6d	78	5000	1800	497,70
ES 11/38	1.876,70	43S 11/38	1.601,60	1100x3800x450	300x260x2	210	140	6d	83	5300	1900	499,10

Prosječna brzina protoka definirana brzinom prolaza ispod haube 0,35m/s.
Average flow rate defined with passage speed under the hood 0.35m/sec.

FILTERI/FILTERS:

- a (400x400) - b (500x400)
- c (400x500) - d (500x500)

ZIDNE NAPE

WALL HOODS

Nape ove serije dizajnirane su i izrađene za korištenje u bilo kojem kuhinjskom okruženju, čak i u malim dimenzijama. Poseban profil čini ga prikladnim za korištenje za sve glavne blokove za kuhanje na zidu. U potpunosti izrađen od nehrđajućeg čelika AISI (304 ili 430 ovisno o modelu) sa scotch brite završnom obradom. Sastavljeno spajanjem spojeva, s ravnomjerno presavijenim rubovima u unutarnjim dijelovima. Perimetralni kanal za skupljanje kondenzata s odvodnom slavinom od 1/2". Labirintski filtri od nehrđajućeg čelika. Ovisno o modelu, nape ove serije mogu biti opremljene električni ventilator, integrirano osvjetljenje i regulator brzine.

The hoods of this series have been designed and built to be used in any kitchen environment, even in small dimensions. The particular profile makes it suitable to be used for all the main cooking blocks on the wall. Entirely made of AISI stainless steel (304 or 430 depending on the model) with scotch brite finish. Assembled by splicing the joints, with edges folded even in the internal parts. Condensate collection perimeter duct with 1/2 "drain tap. Labyrinth filters in stainless steel. Depending on the model, the hoods of this series can be equipped with an electric fan, integrated lighting and speed regulator.

KLASIČNA ZIDNA NAPA BEZ VENTILATORA

Serie 70 / 90 / 110/ 130

CLASSIC WALL HOOD
WITHOUT EXTRACTOR FAN



KONSTRUKCIJSKE KARAKTERISTIKE:

Tradicionalna linija klasične zidne nape omogućuje njezinu upotrebu u svakoj kuhinji, koliko god mala bila. Izrada od AISI 304 ili AISI 430. Posebna izrada na zahtjev.

ISPORUČENO:

- Labirint filtri
- Slavina za ispuštanje kondenzata 1/2"
- Ostale duljine

BILJEŠKE:

Za pribor pogledajte odgovarajuće stranice.
Pakiranje u stretch foliju

CONSTRUCTION CHARACTERISTICS:

The traditional line of the classic wall mounted hood allows it's use in any kitchen, however small. Construction in AISI 304 or AISI 430. Special fabrication on request.

SUPPLIED:

- Baffle filters
- Condensate draining cock 1/2"
- Other lenghts

NOTES:

For the accessories please see the relative pages. Pluriball wrap packaging with polystyrene corners included.

Prosječna brzina protoka definirana brzinom prolaza ispod haube 0,35m/s.

Average flow rate defined with passage speed under the hood 0.35m/sec.

FILTERI/FILTERS:

a (400x400) - b (500x400)
c (400x500) - d (500x500)

ZIDNE NAPE • WALL HOODS

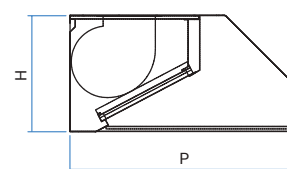
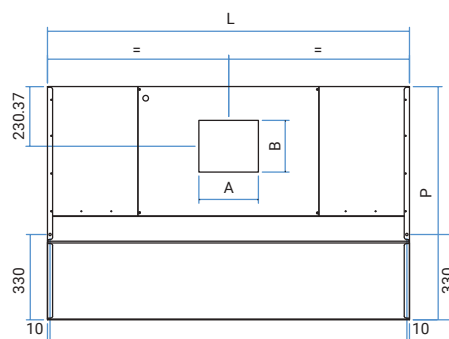
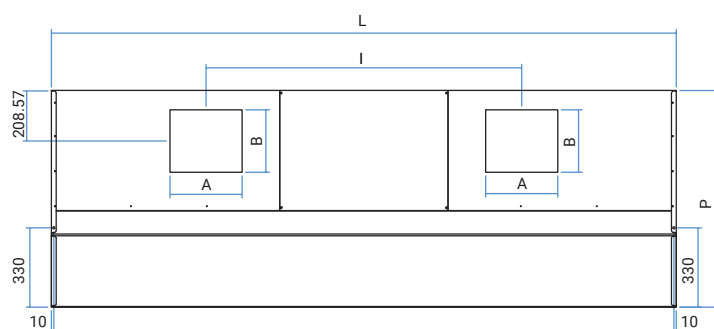

Serie 70

Modeli Models	304 €	Modeli Models	430 €	Dim. PxLxh mm	AxB mm	C mm	D mm	Filteri n° Filters n°	Težina Kg Weight Kg	Vol. MC/H*	I mm	LED €
EP 7/10	665,00	43P 7/10	567,70	700x1000x450	230x200	230	150	2a	26	900		155,40
EP 7/12	735,70	43P 7/12	628,60	700x1200x450	230x200	230	150	2b	30	1100		165,90
EP 7/14	773,50	43P 7/14	661,50	700x1400x450	230x200	230	150	2b	34	1250		242,20
EP 7/16	846,30	43P 7/16	721,70	700x1600x450	230x200	230	150	3a	37	1400		253,40
EP 7/18	907,20	43P 7/18	773,50	700x1800x450	230x200	230	150	3b	40	1600		345,80
EP 7/20	985,60	43P 7/20	841,40	700x2000x450	300x260	210	150	4a	44	1800		357,70
EP 7/22	1.059,80	43P 7/22	905,80	700x2200x450	300x260	210	150	4a	46	1950		368,20
EP 7/24	1.132,60	43P 7/24	966,70	700x2400x450	300x260	210	150	4b	48	2200		404,60
EP 7/26	1.196,30	43P 7/26	1.021,30	700x2600x450	300x260	210	150	4b	51	2300		415,80
EP 7/28	1.281,00	43P 7/28	1.092,70	700x2800x450	230x200x2	230	150	5b	54	2500	1400	427,00
EP 7/30	1.361,50	43P 7/30	1.162,00	700x3000x450	230x200x2	230	150	5b	57	2700	1500	437,50
EP 7/32	1.444,80	43P 7/32	1.232,70	700x3200x450	230x200x2	230	150	5b	61	2800	1600	560,00
EP 7/34	1.570,10	43P 7/34	1.339,10	700x3400x450	300x260x2	210	150	6b	64	3000	1700	572,60
EP 7/36	1.697,50	43P 7/36	1.448,30	700x3600x450	300x260x2	210	150	6b	67	3200	1800	583,10
EP 7/38	1.780,10	43P 7/38	1.519,00	700x3800x450	300x260x2	210	150	6b	71	3350	1900	593,60

Serie 90

Modeli Models	304 €	Modeli Models	430 €	Dim. PxLxh mm	AxB mm	C mm	D mm	Filteri n° Filters n°	Težina Kg Weight Kg	Vol. MC/H*	I mm	LED €
EP 9/10	735,70	43P 9/10	628,60	900x1000x450	230x200	230	140	2a	26	1100		179,20
EP 9/12	773,50	43P 9/12	661,50	900x1200x450	230x200	230	140	2b	30	1400		190,40
EP 9/14	846,30	43P 9/14	721,70	900x1400x450	230x200	230	140	2b	34	1650		267,40
EP 9/16	907,20	43P 9/16	773,50	900x1600x450	230x200	210	140	3a	37	1400		272,30
EP 9/18	985,60	43P 9/18	841,40	900x1800x450	230x200	210	140	3b	40	2000		371,00
EP 9/20	1.059,80	43P 9/20	905,80	900x2000x450	300x260	210	140	4a	44	2250		382,20
EP 9/22	1.132,60	43P 9/22	966,70	900x2200x450	300x260	210	140	4a	46	2500		392,70
EP 9/24	1.196,30	43P 9/24	1.021,30	900x2400x450	300x260	210	140	4b	48	2700		428,40
EP 9/26	1.262,10	43P 9/26	1.092,70	900x2600x450	300x260	210	140	4b	51	2950	1300	439,60
EP 9/28	1.361,50	43P 9/28	1.162,00	900x2800x450	230x200x2	210	140	5b	54	3200	1400	452,20
EP 9/30	1.430,10	43P 9/30	1.221,50	900x3000x450	230x200x2	210	140	5b	57	3400	1500	462,00
EP 9/32	1.497,30	43P 9/32	1.278,20	900x3200x450	230x200x2	210	140	5b	61	3650	1600	585,90
EP 9/34	1.671,60	43P 9/34	1.426,60	900x3400x450	300x260x2	210	140	6b	64	3850	1700	597,10
EP 9/36	1.772,40	43P 9/36	1.512,70	900x3600x450	300x260x2	210	140	6b	67	4050	1800	606,90
EP 9/38	1.818,60	43P 9/38	1.551,20	900x3800x450	300x260x2	210	140	6b	71	4300	1900	618,10

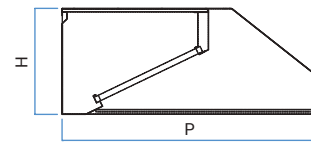
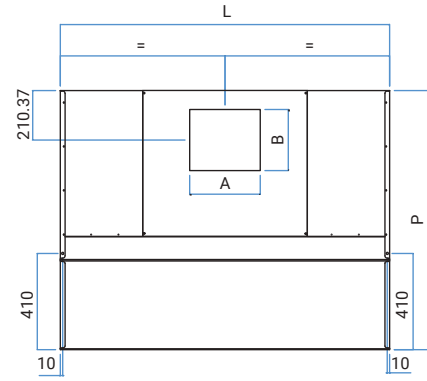
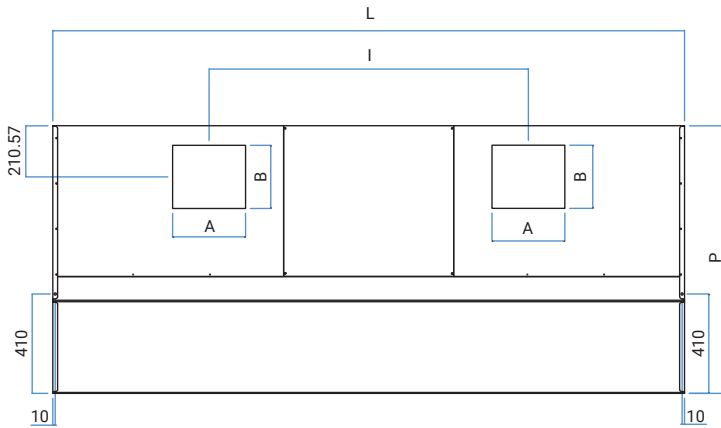

Serie 110

Modeli ModelP	304 €	Modeli ModelP	430 €	Dim. PxLxh mm	AxB mm	C mm	D mm	Filteri n° FilterP n°	Težina Kg Weight Kg	Vol. MC/H*	I mm	LED €
EP 11/10	754,60	43P 11/10	643,30	1100x1000x450	230x200	230	410	2c	35	1400		207,20
EP 11/12	822,50	43P 11/12	701,40	1100x1200x450	300x260	210	410	2d	38	1700		287,00
EP 11/14	893,20	43P 11/14	763,00	1100x1400x450	300x260	210	410	2d	41	1950		300,30
EP 11/16	963,20	43P 11/16	822,50	1100x1600x450	300x260	210	410	3c	44	2200		392,70
EP 11/18	1.047,90	43P 11/18	893,20	1100x1800x450	300x260	210	410	3d	47	2500		405,30
EP 11/20	1.129,80	43P 11/20	963,90	1100x2000x450	300x260	210	410	4c	50	2800		420,00
EP 11/22	1.201,90	43P 11/22	1.026,20	1100x2200x450	300x260	210	410	4c	53	3100		460,60
EP 11/24	1.274,00	43P 11/24	1.086,40	1100x2400x450	300x260x2	210	410	4d	56	3400	1200	473,20
EP 11/26	1.360,80	43P 11/26	1.162,00	1100x2600x450	300x260x2	210	410	4d	59	3600	1300	486,50
EP 11/28	1.446,20	43P 11/28	1.233,40	1100x2800x450	230x200x2	210	410	5d	62	3900	1400	500,50
EP 11/30	1.521,10	43P 11/30	1.298,50	1100x3000x450	230x200x2	210	410	5d	65	4200	1500	627,20
EP 11/32	1.598,10	43P 11/32	1.363,60	1100x3200x450	230x200x2	210	410	5d	68	4500	1600	639,80
EP 11/34	1.787,10	43P 11/34	1.523,90	1100x3400x450	300x260x2	210	410	6d	73	4700	1700	651,70
EP 11/36	1.887,20	43P 11/36	1.610,00	1100x3600x450	300x260x2	210	410	6d	78	5000	1800	665,70
EP 11/38	1.941,10	43P 11/38	1.656,90	1100x3800x450	300x260x2	210	410	6d	83	5300	1900	522,90

Serie 130

Modeli Models	304 €	Modeli Models	430 €	Dim. PxLxh mm	AxB mm	C mm	D mm	Filteri n° Filters n°	Težina Kg Weight Kg	Vol. MC/H*	I mm	LED €
EP 13/12	850,50	43P 13/12	740,60	1300x1200x450	250x250	300	500	2d	39	1400		229,60
EP 13/14	924,70	43P 13/14	805,70	1300x1400x450	250x250	300	500	2d	42	1650		312,20
EP 13/16	999,60	43P 13/16	870,80	1300x1600x450	300x300	300	500	3c	45	1400		327,60
EP 13/18	1.085,00	43P 13/18	945,00	1300x1800x450	300x300	300	500	3d	48	2000		424,20
EP 13/20	1.180,90	43P 13/20	1.029,00	1300x2000x450	300x300	300	500	4c	52	2250		439,60
EP 13/22	1.278,20	43P 13/22	1.113,70	1300x2200x450	300x300	300	500	4c	56	2500		456,40
EP 13/24	1.364,30	43P 13/24	1.188,60	1300x2400x450	300x300x2	300	500	4d	60	2700	1200	500,50
EP 13/26	1.421,00	43P 13/26	1.237,60	1300x2600x450	300x300x2	300	500	4d	63	2950	1300	516,60
EP 13/28	1.528,80	43P 13/28	1.332,10	1300x2800x450	300x300x2	300	500	5d	66	3200	1400	532,00
EP 13/30	1.610,70	43P 13/30	1.402,10	1300x3000x450	300x300x2	300	500	5d	71	3400	1500	549,50
EP 13/32	1.662,50	43P 13/32	1.448,30	1300x3200x450	300x300x2	300	500	5d	75	3650	1600	679,00
EP 13/34	1.805,30	43P 13/34	1.571,50	1300x3400x450	400x400x2	300	500	6d	83	3850	1700	701,40
EP 13/36	1.937,60	43P 13/36	1.687,70	1300x3600x450	400x400x2	300	500	6d	87	4050	1800	712,60
EP 13/38	1.995,00	43P 13/38	1.736,70	1300x3800x450	400x400x2	300	500	6d	90	4300	1900	728,70

TANKA ZIDNA NAPA BEZ MOTORA

Serie 70 / 90 / 110 / 130

SLIM WALL HOOD
WITHOUT EXTRACTOR FAN



KONSTRUKCIJSKE KARAKTERISTIKE:

“Slim” verzija klasične zidne nape omogućuje da se koristi u bilo kojem kuhinjskom okruženju, čak i ako je mala zahvaljujući svojoj liniji koja štedi prostor. Izrada od AISI 304 ili AISI 430. Posebna izrada na zahtjev.

ISPORUČENO:

- Labirint filtri
- Slavina za ispuštanje kondenzata 1/2"
- Ostale duljine

BILJEŠKE:

Za pribor pogledajte odgovarajuće stranice. Pakiranje u stretch foliju

CONSTRUCTION CHARACTERISTICS:

The “slim” version of the classic wall mounted hood allows it to be used in any kitchen environment, even if it’s small thanks to its space-saving line. Construction in AISI 304 or AISI 430. Special fabrication on request.

SUPPLIED:

- Baffle filters
- Condensate draining cock 1/2"
- Other lengths

NOTES:

For the accessories please see the relative pages. Pluriball wrap packaging with polystyrene corners included.

Prosječna brzina protoka definirana brzinom prolaza ispod haube 0,35m/s.
Average flow rate defined with passage speed under the hood 0.35m/sec.

FILTERI/FILTERS:

a (400x400) - b (500x400)
c (400x500) - d (500x500)

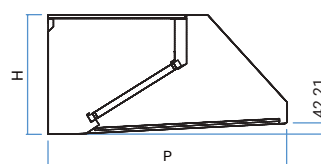
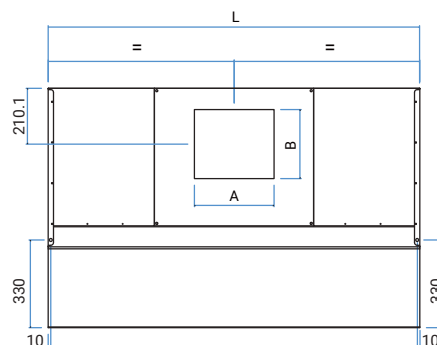
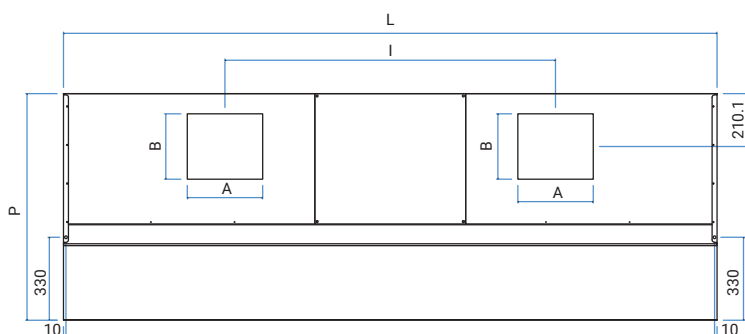

Serie 70

Modeli Models	304 €	Modeli Models	430 €	Dim. PxLxh mm	AxB mm	C mm	Filteri n° Filters n°	Težina Kg Weight Kg	Vol. MC/H*	I mm	LED €
EP-SLIM 7/10	665,00	43P-SLIM 7/10	567,70	700x1000x450	230x200	230	2a	26	900		155,40
EP-SLIM 7/12	735,70	43P-SLIM 7/12	628,60	700x1200x450	230x200	230	2b	30	1100		165,90
EP-SLIM 7/14	773,50	43P-SLIM 7/14	661,50	700x1400x450	230x200	230	2b	34	1250		242,20
EP-SLIM 7/16	846,30	43P-SLIM 7/16	721,70	700x1600x450	230x200	230	3a	37	1400		253,40
EP-SLIM 7/18	907,20	43P-SLIM 7/18	773,50	700x1800x450	230x200	210	3b	40	1600		345,80
EP-SLIM 7/20	985,60	43P-SLIM 7/20	841,40	700x2000x450	300x260	210	4a	44	1800		357,70
EP-SLIM 7/22	1.059,80	43P-SLIM 7/22	905,80	700x2200x450	300x260	210	4a	46	1950		368,20
EP-SLIM 7/24	1.132,60	43P-SLIM 7/24	966,70	700x2400x450	300x260	210	4b	48	2200		404,60
EP-SLIM 7/26	1.196,30	43P-SLIM 7/26	1.021,30	700x2600x450	300x260	210	4b	51	2300		415,80
EP-SLIM 7/28	1.281,00	43P-SLIM 7/28	1.092,70	700x2800x450	230x200x2	230	5b	54	2500	1400	427,00
EP-SLIM 7/30	1.361,50	43P-SLIM 7/30	1.162,00	700x3000x450	230x200x2	230	5b	57	2700	1500	437,50
EP-SLIM 7/32	1.444,80	43P-SLIM 7/32	1.232,70	700x3200x450	230x200x2	230	5b	61	2800	1600	560,00
EP-SLIM 7/34	1.570,10	43P-SLIM 7/34	1.339,10	700x3400x450	300x260x2	210	6b	64	3000	1700	572,60
EP-SLIM 7/36	1.697,50	43P-SLIM 7/36	1.448,30	700x3600x450	300x260x2	210	6b	67	3200	1800	583,10
EP-SLIM 7/38	1.780,10	43P-SLIM 7/38	1.519,00	700x3800x450	300x260x2	210	6b	71	3350	1900	593,60

Serie 90

Modeli Models	304 €	Modeli Models	430 €	Dim. PxLxh mm	AxB mm	C mm	Filteri n° Filters n°	Težina Kg Weight Kg	Vol. MC/H*	I mm	LED €
EP-SLIM 9/10	735,70	43P-SLIM 9/10	692,30	900x1000x450	230x200	230	2a	28	1100		179,20
EP-SLIM 9/12	773,50	43P-SLIM 9/12	661,50	900x1200x450	230x200	230	2b	30	1400		190,40
EP-SLIM 9/14	846,30	43P-SLIM 9/14	721,70	900x1400x450	230x200	230	2b	35	1650		267,40
EP-SLIM 9/16	888,30	43P-SLIM 9/16	773,50	900x1600x450	300x260	210	3a	38	1400		278,60
EP-SLIM 9/18	985,60	43P-SLIM 9/18	841,40	900x1800x450	300x260	210	3b	40	2000		371,00
EP-SLIM 9/20	1.059,80	43P-SLIM 9/20	905,80	900x2000x450	300x260	210	4a	46	2250		382,20
EP-SLIM 9/22	1.132,60	43P-SLIM 9/22	966,70	900x2200x450	300x260	210	4a	49	2500		392,70
EP-SLIM 9/24	1.196,30	43P-SLIM 9/24	1021,30	900x2400x450	300x260	210	4b	52	2700		428,40
EP-SLIM 9/26	1.281,00	43P-SLIM 9/26	1092,70	900x2600x450	300x260x2	210	4b	55	2950	1300	439,60
EP-SLIM 9/28	1.361,50	43P-SLIM 9/28	1162,00	900x2800x450	300x260x2	210	5b	60	3200	1400	452,20
EP-SLIM 9/30	1.430,10	43P-SLIM 9/30	1221,50	900x3000x450	300x260x2	210	5b	64	3400	1500	462,00
EP-SLIM 9/32	1.497,30	43P-SLIM 9/32	1278,20	900x3200x450	300x260x2	210	5b	67	3650	1600	585,90
EP-SLIM 9/34	1.671,60	43P-SLIM 9/34	1426,60	900x3400x450	300x260x2	210	6b	70	3850	1700	597,10
EP-SLIM 9/36	1.772,40	43P-SLIM 9/36	1512,70	900x3600x450	300x260x2	210	6b	74	4050	1800	606,90
EP-SLIM 9/38	1.818,60	43P-SLIM 9/38	1551,20	900x3800x450	300x260x2	210	6b	77	4300	1900	618,10

ZIDNE NAPE • WALL HOODS

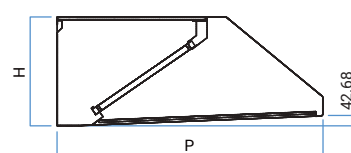
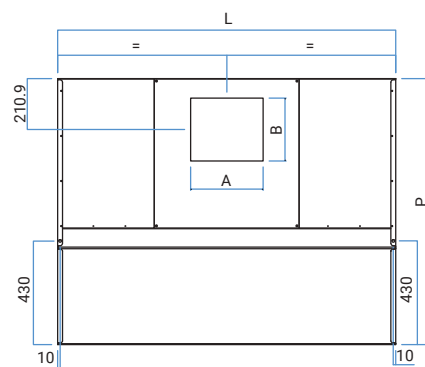
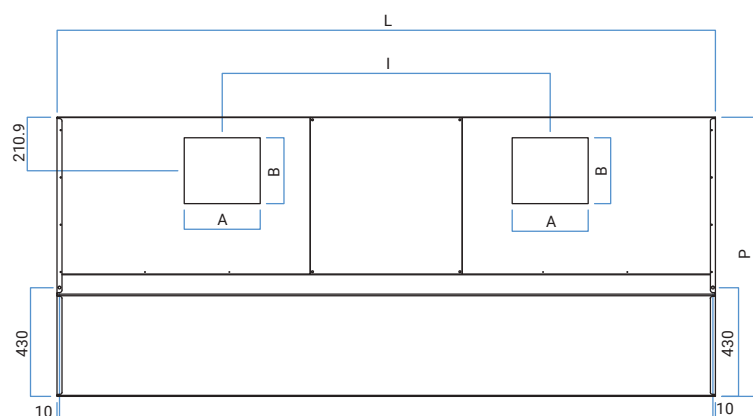

Serie 110

Modeli Models	304 €	Modeli Models	430 €	Dim. PxLxh mm	AxB mm	C mm	Filteri n° FilterP n°	Težina Kg Weight Kg	Vol. MC/H*	I mm	LED €
EP-SLIM 11/10	754,60	43P-SLIM 11/10	643,30	1100x1000x450	230x200	230	2c	35	1400		207,20
EP-SLIM 11/12	822,50	43P-SLIM 11/12	701,40	1100x1200x450	300x260	210	2d	38	1700		287,00
EP-SLIM 11/14	893,20	43P-SLIM 11/14	763,00	1100x1400x450	300x260	210	2d	41	1950		300,30
EP-SLIM 11/16	963,20	43P-SLIM 11/16	822,50	1100x1600x450	300x260	210	3c	44	2200		392,70
EP-SLIM 11/18	1.047,90	43P-SLIM 11/18	893,20	1100x1800x450	300x260	210	3d	47	2500		405,30
EP-SLIM 11/20	1.129,80	43P-SLIM 11/20	963,90	1100x2000x450	300x260	210	4c	50	2800		420,00
EP-SLIM 11/22	1.201,90	43P-SLIM 11/22	1.026,20	1100x2200x450	300x260	210	4c	53	3100		460,60
EP-SLIM 11/24	1.274,00	43P-SLIM 11/24	1.086,40	1100x2400x450	300x260x2	210	4d	56	3400	1200	473,20
EP-SLIM 11/26	1.360,80	43P-SLIM 11/26	1.162,00	1100x2600x450	300x260x2	210	4d	59	3600	1300	486,50
EP-SLIM 11/28	1.446,20	43P-SLIM 11/28	1.233,40	1100x2800x450	300x260x2	210	5d	62	3900	1400	500,50
EP-SLIM 11/30	1.521,10	43P-SLIM 11/30	1.298,50	1100x3000x450	300x260x2	210	5d	65	4200	1500	627,20
EP-SLIM 11/32	1.598,10	43P-SLIM 11/32	1.363,60	1100x3200x450	300x260x2	210	5d	68	4500	1600	639,80
EP-SLIM 11/34	1.787,10	43P-SLIM 11/34	1.523,90	1100x3400x450	300x260x2	210	6d	73	4700	1700	651,70
EP-SLIM 11/36	1.845,20	43P-SLIM 11/36	1.610,00	1100x3600x450	300x260x2	210	6d	78	5000	1800	665,70
EP-SLIM 11/38	1.941,10	43P-SLIM 11/38	1.656,90	1100x3800x450	300x260x2	210	6d	83	5300	1900	522,90

Serie 130

Modeli Models	304 €	Modeli Models	430 €	Dim. PxLxh mm	AxB mm	C mm	Filteri n° Filters n°	Težina Kg Weight Kg	Vol. MC/H*	I mm	LED €
EP-SLIM 13/12	850,50	43P-SLIM 13/12	740,60	1300x1200x450	250x250	300	2d	39	2100		229,60
EP-SLIM 13/14	924,70	43P-SLIM 13/14	805,70	1300x1400x450	250x250	300	2d	42	2500		312,20
EP-SLIM 13/16	999,60	43P-SLIM 13/16	870,80	1300x1600x450	300x300	300	3c	45	2800		327,60
EP-SLIM 13/18	1.085,00	43P-SLIM 13/18	945,00	1300x1800x450	300x300	300	3d	48	3200		424,20
EP-SLIM 13/20	1.180,90	43P-SLIM 13/20	1.029,00	1300x2000x450	300x300	300	4c	52	3500		439,60
EP-SLIM 13/22	1.278,20	43P-SLIM 13/22	1.113,70	1300x2200x450	300x300	300	4c	56	3900		456,40
EP-SLIM 13/24	1.364,30	43P-SLIM 13/24	1.188,60	1300x2400x450	300x300x2	300	4d	60	4200	1200	500,50
EP-SLIM 13/26	1.421,00	43P-SLIM 13/26	1.237,60	1300x2600x450	400x300x2	300	4d	63	4600	1300	516,60
EP-SLIM 13/28	1.528,80	43P-SLIM 13/28	1.332,10	1300x2800x450	400x300x2	300	5d	66	4900	1400	532,00
EP-SLIM 13/30	1.610,70	43P-SLIM 13/30	1.402,10	1300x3000x450	400x300x2	300	5d	71	5300	1500	549,50
EP-SLIM 13/32	1.662,50	43P-SLIM 13/32	1.448,30	1300x3200x450	400x300x2	300	5d	75	5600	1600	679,00
EP-SLIM 13/34	1.805,30	43P-SLIM 13/34	1.571,50	1300x3400x450	400x400x2	300	6d	83	6000	1700	701,40
EP-SLIM 13/36	1.937,60	43P-SLIM 13/36	1.687,70	1300x3600x450	400x400x2	300	6d	87	6400	1800	712,60
EP-SLIM 13/38	1.995,00	43P-SLIM 13/38	1.736,70	1300x3800x450	400x400x2	300	6d	90	6700	1900	728,70

CENTRALNE NAPE

ISLAND HOODS

Nape ove serije dizajnirane su i izrađene za korištenje u bilo kojem kuhinjskom okruženju, čak i u slučaju niskih stropova. Poseban profil ga čini pogodnim za korištenje za centralno postavljene blokove za kuhanje. U potpunosti izrađen od nehrđajućeg čelika Aisi (304 ili 430 ovisno o model) sa scotch brite završnom obradom. Sastavljeno točkastim zavarivanjem s ravnomjerno presavijenim rubovima u unutarnjim dijelovima. Perimetrijski kanal za skupljanje kondenzata s odvodnom slavinom od 1/2". Labirintski filtri od nehrđajućeg čelika. Ovisno o modelu, nape ove serije mogu biti opremljene električnim ventilatorom, integriranim osvjetljenjem i regulatorom brzine.

The hoods of this series have been designed and built to be used in any kitchen environment, even in the case of low ceilings. The particular profile makes it suitable to be used for centrally positioned cooking blocks. Entirely made of Aisi stainless steel (304 or 430 depending on the model) with scotch brite finish. Assembled by spot-welding with edges folded even in the internal parts. Condensate collection perimetric duct with 1/2" drain tap. Labyrinth filters in stainless steel. Depending on the model, the hoods of this series can be equipped with an electric fan, integrated lighting and speed regulator.



CENTRALNE NAPE EC-S LINE

Serie 120 / 140 / 180

ISLAND HOODS EC-S LINE

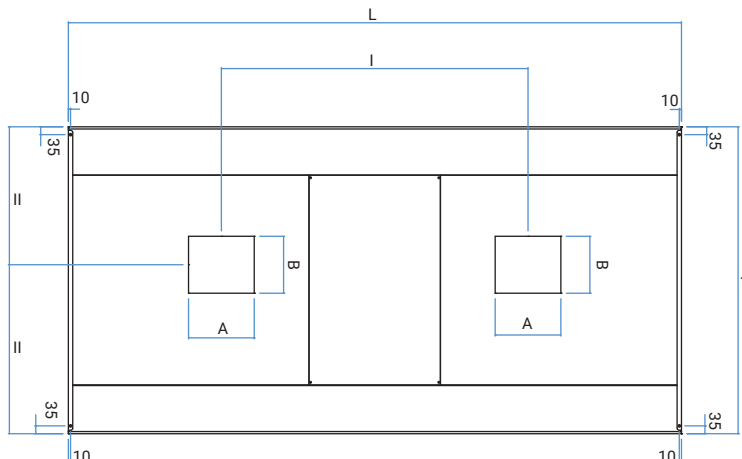
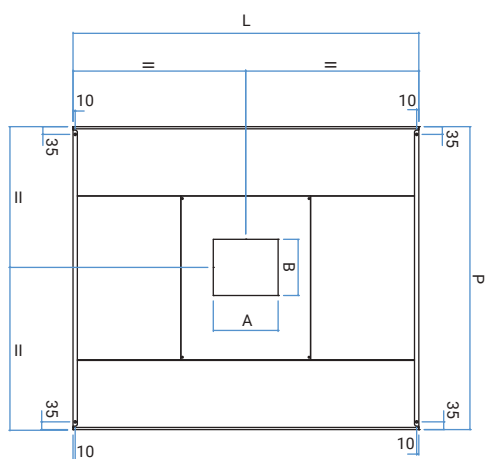
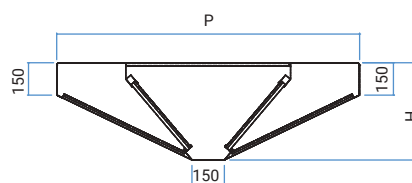

Serie 120

Modeli Models	304 €	Modeli Models	430 €	Dim. PxLxh mm	AxB mm	Filteri n° Filters n°	Težina Kg Weight Kg	Vol. MC/H*	I mm	LED €
EC-S 12/12	868,70	43EC-S 12/12	753,20	1200x1200x450	200x200	4b	37	1800		208,00
EC-S 12/14	935,90	43EC-S 12/14	802,90	1200x1400x450	250x250	4b	40	2100		307,00
EC-S 12/16	1.036,00	43EC-S 12/16	889,00	1200x1600x450	250x250	6a	47	2400		309,00
EC-S 12/18	1.115,10	43EC-S 12/18	957,60	1200x1800x450	250x250	6b	50	2700		429,00
EC-S 12/20	1.211,70	43EC-S 12/20	1.037,40	1200x2000x450	300x300	8b	57	3000		434,00
EC-S 12/22	1.304,10	43EC-S 12/22	1.113,70	1200x2200x450	300x300	8b	61	3300		440,00
EC-S 12/24	1.388,80	43EC-S 12/24	1.188,60	1200x2400x450	300x300	8b	64	3600		483,00
EC-S 12/26	1.470,70	43EC-S 12/26	1.252,30	1200x2600x450	300x300	8b	67	3900		488,00
EC-S 12/28	1.573,60	43EC-S 12/28	1.351,70	1200x2800x450	250x250x2	10b	72	4200	1400	490,00
EC-S 12/30	1.650,60	43EC-S 12/30	1.407,70	1200x3000x450	250x250x2	10b	77	4500	1500	494,00
EC-S 12/32	1.863,40	43EC-S 12/32	1.602,30	1200x3200x450	250x250x2	10b	81	4800	1600	658,00
EC-S 12/34	1.970,50	43EC-S 12/34	1.703,80	1200x3400x450	300x300x2	12b	86	5100	1700	660,00
EC-S 12/36	2.043,30	43EC-S 12/36	1.755,60	1200x3600x450	300x300x2	12b	91	5400	1800	663,00
EC-S 12/38	2.146,20	43EC-S 12/38	1.855,00	1200x3800x450	300x300x2	12b	95	5700	1900	667,00

KONSTRUKCIJSKE KARAKTERISTIKE:

Poseban profil čini Centralne nape idealnim za različite blokove za kuhanje smještene na otoku, čak i kod kuhinja s niskim stropom. Izrada od AISI 304 ili AISI 430. Posebna izrada na zahtjev.

ISPORUČENO:

- Labirint filtri
- Slavina za ispuštanje kondenzata 1/2"
- Ostale duljine

BILJEŠKE:

Za pribor pogledajte odgovarajuće stranice. Pakiranje u stretch foliju

Serie 140

Modeli Models	304 €	Modeli Models	430 €	Dim. PxLxh mm	AxB mm	Filteri n° Filters n°	Težina Kg Weight Kg	Vol. MC/H*	I mm	LED €
EC-S 14/12	909,30	43EC-S 14/12	783,30	1400x1200x450	250x250	4b	38	2100		290,50
EC-S 14/14	980,00	43EC-S 14/14	835,10	1400x1400x450	250x250	4b	43	2500		429,80
EC-S 14/16	1.079,40	43EC-S 14/16	921,20	1400x1600x450	300x300	6a	50	2800		434,00
EC-S 14/18	1.164,80	43EC-S 14/18	993,30	1400x1800x450	300x300	6b	54	3200		601,30
EC-S 14/20	1.297,80	43EC-S 14/20	1.110,20	1400x2000x450	300x300	8a	60	3500		606,20
EC-S 14/22	1.406,30	43EC-S 14/22	1.194,90	1400x2200x450	400x300	8a	66	3900		616,00
EC-S 14/24	1.493,80	43EC-S 14/24	1.269,80	1400x2400x450	400x300	8b	69	4200		676,90
EC-S 14/26	1.583,40	43EC-S 14/26	1.337,70	1400x2600x450	300x260	8b	74	4600	1300	683,20
EC-S 14/28	1.726,20	43EC-S 14/28	1.474,90	1400x2800x450	300x300x2	10b	79	4900	1400	686,70
EC-S 14/30	1.810,20	43EC-S 14/30	1.569,40	1400x3000x450	300x300x2	10b	84	5300	1500	692,30
EC-S 14/32	1.984,50	43EC-S 14/32	1.690,50	1400x3200x450	300x300x2	10b	89	5600	1600	920,50
EC-S 14/34	2.097,90	43EC-S 14/34	1.796,20	1400x3400x450	300x300x2	12b	94	6000	1700	924,70
EC-S 14/36	2.177,70	43EC-S 14/36	1.854,30	1400x3600x450	300x300x2	12b	99	6400	1800	928,20
EC-S 14/38	2.286,90	43EC-S 14/38	1.957,90	1400x3800x450	300x300x2	12b	104	6700	1900	933,80

CONSTRUCTION CHARACTERISTICS:

The special profile makes it ideal for different wall cooking blocks island positioned, even with low ceilings. Construction in AISI 304 or AISI 430. Special fabrication on request.

SUPPLIED:

- Baffle filters
- Condensate draining cock 1/2"
- Other lengths

NOTES:

For the accessories please see the relative pages. Pluriball wrap packaging with polystyrene corners included.

Serie 180

Modeli Models	304 €	Modeli Models	430 €	Dim. PxLxh mm	AxB mm	Filteri n° Filters n°	Težina Kg Weight Kg	Vol. MC/H*	I mm	LED €
EC-S 18/12	1.022,00	43EC-S 18/12	874,30	1800x1200x450	300x300	2d	43	2750		324,80
EC-S 18/14	1.107,40	43EC-S 18/14	938,00	1800x1400x450	300x300	3c	49	3200		462,00
EC-S 18/16	1.216,60	43EC-S 18/16	1.031,10	1800x1600x450	300x300	3c	6	3650		467,60
EC-S 18/18	1.353,10	43EC-S 18/18	1.149,40	1800x1800x450	400x300	3d	61	4050		634,90
EC-S 18/20	1.456,00	43EC-S 18/20	1.234,10	1800x2000x450	400x300	4c	68	4550		639,10
EC-S 18/22	1.560,30	43EC-S 18/22	1.316,70	1800x2200x450	400x300	4c	73	5000		650,30
EC-S 18/24	1.652,70	43EC-S 18/24	1.397,20	1800x2400x450	300x300x2	4d	76	5450	1200	709,10
EC-S 18/26	1.761,20	43EC-S 18/26	1.482,60	1800x2600x450	300x300x2	4d	82	5900	1300	714,70
EC-S 18/28	1.892,80	43EC-S 18/28	1.607,20	1800x2800x450	300x300x2	5d	87	6350	1400	718,20
EC-S 18/30	1.988,00	43EC-S 18/30	1.677,20	1800x3000x450	400x300x2	5d	93	6800	1500	724,50
EC-S 18/32	2.149,00	43EC-S 18/32	1.817,20	1800x3200x450	400x300x2	5d	98	7250	1600	952,70
EC-S 18/34	2.270,80	43EC-S 18/34	1.928,50	1800x3400x450	400x300x2	6d	104	7700	1700	956,20
EC-S 18/36	2.356,90	43EC-S 18/36	1.992,20	1800x3600x450	400x300x2	6d	109	8200	1800	960,40
EC-S 18/38	2.428,30	43EC-S 18/38	2.055,20	1800x3800x450	400x300x2	6d	115	8600	1900	966,00

Prosječna brzina protoka definirana brzinom prolaza ispod haube 0,35m/s.
Average flow rate defined with passage speed under the hood 0.35m/sec.

FILTERI/FILTERS:

- a (400x400) - b (500x400)
- c (400x500) - d (500x500)

CENTRALNE NAPE BEZ LINIJSKOG VENTILATORA

Serie 140 / 180 / 220

ISLAND HOODS WITHOUT
LINE EXTRACTION FAN

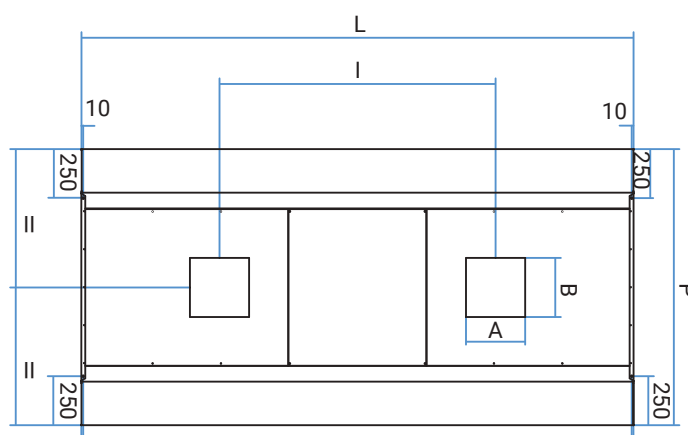
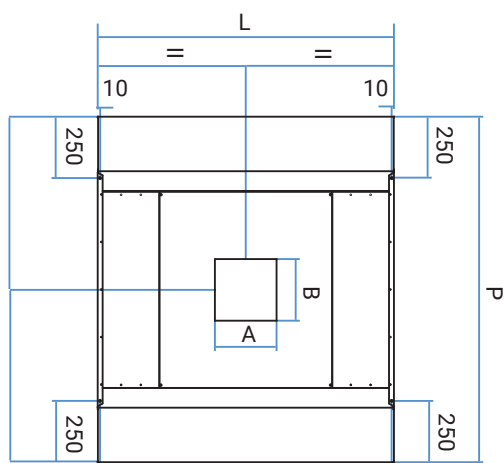
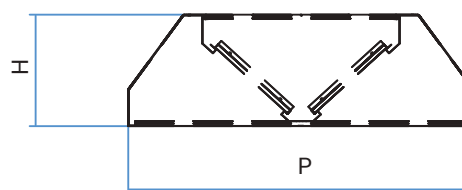

Serie 140

Modeli Models	304 €	Modeli Models	430 €	Dim. PxLxh mm	AxB mm	D mm	Filteri n° Filters n°	Težina Kg Weight Kg	Vol. MC/H*	I mm	LED €
EC 14/12	974,40	43C 14/12	823,90	1400x1200x450	250x250	250	4b	60	2100		331,10
EC 14/14	1.067,50	43C 14/14	902,30	1400x1400x450	250x250	250	4b	64	2500		484,40
EC 14/16	1.136,10	43C 14/16	960,40	1400x1600x450	300x300	250	6a	68	2800		508,20
EC 14/18	1.263,50	43C 14/18	1.067,50	1400x1800x450	300x300	250	6b	72	3200		692,30
EC 14/20	1.375,50	43C 14/20	1.162,70	1400x2000x450	300x300	250	8a	76	3500		714,70
EC 14/22	1.437,10	43C 14/22	1.214,50	1400x2200x450	400x300	250	8a	80	3900		735,70
EC 14/24	1.584,80	43C 14/24	1.338,40	1400x2400x450	400x300	250	8b	84	4200		807,80
EC 14/26	1.640,80	43C 14/26	1.387,40	1400x2600x450	300x260	250	8b	88	4600	1300	831,60
EC 14/28	1.788,50	43C 14/28	1.510,60	1400x2800x450	300x300x2	250	10b	92	4900	1400	854,00
EC 14/30	1.893,50	43C 14/30	1.600,90	1400x3000x450	300x300x2	250	10b	96	5300	1500	874,30
EC 14/32	2.007,60	43C 14/32	1.668,10	1400x3200x450	300x300x2	250	10b	100	5600	1600	1.120,00
EC 14/34	2.148,30	43C 14/34	1.814,40	1400x3400x450	300x300x2	250	12b	104	6000	1700	1.144,50
EC 14/36	2.233,00	43C 14/36	1.885,80	1400x3600x450	300x300x2	250	12b	108	6400	1800	1.166,20
EC 14/38	2.326,10	43C 14/38	1.965,60	1400x3800x450	300x300x2	250	12b	120	6700	1900	1.186,50

KONSTRUKCIJSKE KARAKTERISTIKE:

Tradicionalna linija modela Centralne nape "EC" omogućuje korištenje u svakoj kuhinji, koliko god mala bila. Izrada od AISI 304 ili AISI 430. Posebna izrada na zahtjev.

ISPORUČENO:

- Labirint filtri
- Slavina za ispuštanje kondenzata 1/2"
- Ostale duljine

BILJEŠKE:

Za pribor pogledajte odgovarajuće stranice. Pakiranje u stretch foliju

Serie 180

Modeli Models	304 €	Modeli Models	430 €	Dim. PxLxh mm	AxB mm	D mm	Filteri n° Filters n°	Težina Kg Weight Kg	Vol. MC/H*	I mm	LED €
EC 18/12	1.136,10	43C 18/12	960,40	1800x1200x450	300x300	320	4d	64	2750		380,10
EC 18/14	1.277,50	43C 18/14	1.078,70	1800x1400x450	300x300	320	6c	68	3200		534,80
EC 18/16	1.352,40	43C 18/16	1.142,40	1800x1600x450	300x300	320	6c	72	3650		557,20
EC 18/18	1.472,80	43C 18/18	1.244,60	1800x1800x450	400x300	320	6d	76	4050		742,00
EC 18/20	1.657,60	43C 18/20	1.400,70	1800x2000x450	400x300	320	8c	80	4550		764,40
EC 18/22	1.724,80	43C 18/22	1.457,40	1800x2200x450	400x300	320	8c	84	5000		785,40
EC 18/24	1.872,50	43C 18/24	1.582,70	1800x2400x450	300x300x2	320	8d	88	5450	1200	857,50
EC 18/26	1.936,90	43C 18/26	1.635,90	1800x2600x450	300x300x2	320	8d	92	5900	1300	880,60
EC 18/28	2.125,20	43C 18/28	1.795,50	1800x2800x450	300x300x2	320	10d	96	6350	1400	903,00
EC 18/30	2.256,10	43C 18/30	1.906,80	1800x3000x450	400x300x2	320	10d	100	6800	1500	924,70
EC 18/32	2.324,00	43C 18/32	1.963,50	1800x3200x450	400x300x2	320	10d	106	7250	1600	1.171,10
EC 18/34	2.423,40	43C 18/34	2.048,20	1800x3400x450	400x300x2	320	12d	112	7700	1700	1.194,20
EC 18/36	2.584,40	43C 18/36	2.182,60	1800x3600x450	400x300x2	320	12d	116	8200	1800	1.215,20
EC 18/38	2.664,20	43C 18/38	2.251,20	1800x3800x450	400x300x2	320	12d	123	8600	1900	1.235,50

CONSTRUCTION CHARACTERISTICS:

The traditional line of the island hood model "EC" allows it to be used in any kitchen, however small. Construction in AISI 304 or AISI 430. Special fabrication on request.

SUPPLIED:

- Baffle filters
- Condensate draining cock 1/2"
- Other lengths

NOTES:

For the accessories please see the relative pages. Pluriball wrap packaging with polystyrene corners included.

Serie 220

Modeli Models	304 €	Modeli Models	430 €	Dim. PxLxh mm	AxB mm	D mm	Filteri n° Filters n°	Težina Kg Weight Kg	Vol. MC/H*	I mm	LED €
EC 22/12	1.240,40	43C 22/12	1.047,90	2200x1200x450	300x300	520	4d	71	3300		415,10
EC 22/14	1.380,40	43C 22/14	1.166,90	2200x1400x450	300x300	520	6c	75	3900		574,70
EC 22/16	1.459,50	43C 22/16	1.233,40	2200x1600x450	400x300	520	6c	73	4450		601,30
EC 22/18	1.635,20	43C 22/18	1.381,80	2200x1800x450	400x300	520	6d	83	5000		785,40
EC 22/20	1.820,70	43C 22/20	1.472,80	2200x2000x450	400x300	520	8c	87	5550		809,90
EC 22/22	1.913,10	43C 22/22	1.551,20	2200x2200x450	400x300	520	8c	91	6100		840,70
EC 22/24	1.988,00	43C 22/24	1.680,00	2200x2400x450	300x300x2	520	8d	96	6650	1200	920,50
EC 22/26	2.106,30	43C 22/26	1.779,40	2200x2600x450	300x300x2	520	8d	101	7200	1300	947,10
EC 22/28	2.320,50	43C 22/28	1.960,00	2200x2800x450	300x300x2	520	10d	106	7800	1400	973,70
EC 22/30	2.426,90	43C 22/30	2.049,60	2200x3000x450	400x300x2	520	10d	110	8300	1500	1.000,30
EC 22/32	2.520,00	43C 22/32	2.128,70	2200x3200x450	400x300x2	520	10d	115	8850	1600	1.253,00
EC 22/34	2.714,60	43C 22/34	2.208,50	2200x3400x450	400x300x2	520	12d	120	9450	1700	1.279,60
EC 22/36	2.849,70	43C 22/36	2.408,00	2200x3600x450	400x300x2	520	12d	125	10000	1800	1.304,80
EC 22/38	2.958,20	43C 22/38	2.498,30	2200x3800x450	400x300x2	520	12d	130	15000	1900	1.331,40

*Za nape dubine veće od 2000 mm, minimalna visina 500 mm

*For hoods with a depth greater than 2000 mm, minimum height of 500 mm

Prosječna brzina protoka definirana brzinom prolaza ispod haube 0,35m/s.
Average flow rate defined with passage speed under the hood 0.35m/sec.

FILTERI/FILTERS:

a (400x400) - b (500x400)
c (400x500) - d (500x500)

ZAVARENE NAPE

WELDED HOODS

U potpunosti izrađene od nehrđajućeg čelika AISI 304 sa scotch brite završnim slojem. Potpuno zavarena struktura s rubovima presavijenim čak iu unutarnjim dijelovima. Perimetrijski kanal za skupljanje kondenzata s odvodnom slavinom od 1/2", labirint filteri nehrđajućem čeliku. Ovisno o modelu, nape ove serije mogu biti opremljene električnim ventilatorom, integriranim osvjetljenjem i regulatorom brzine.

Entirely made of AISI 304 stainless steel with scotch brite finish satin. Fully welded structure with edges folded even in the internal parts. Condensate collection perimetric duct with 1/2" drain tap. Labyrinth filters in stainless steel. Depending on the model, the hoods of this series can be equipped with an electric fan, integrated lighting and speed regulator

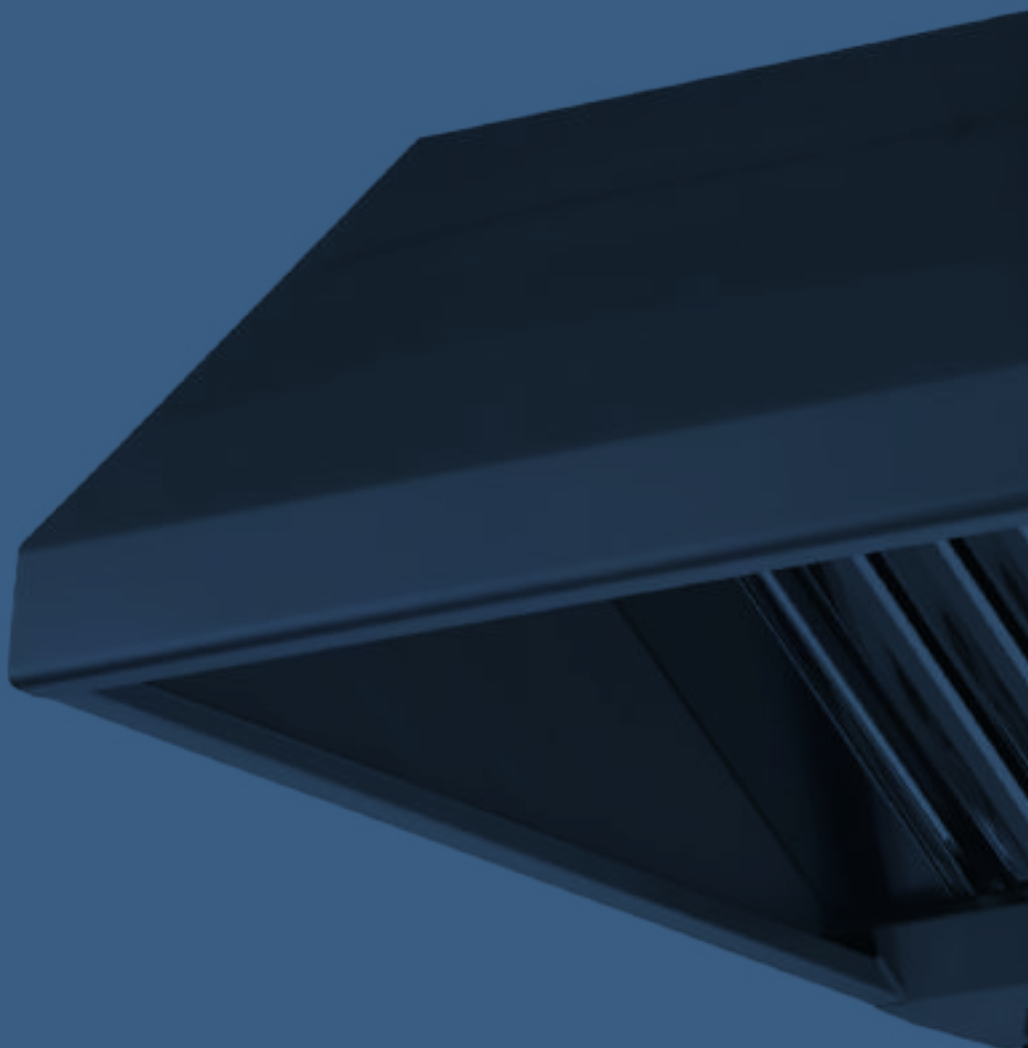

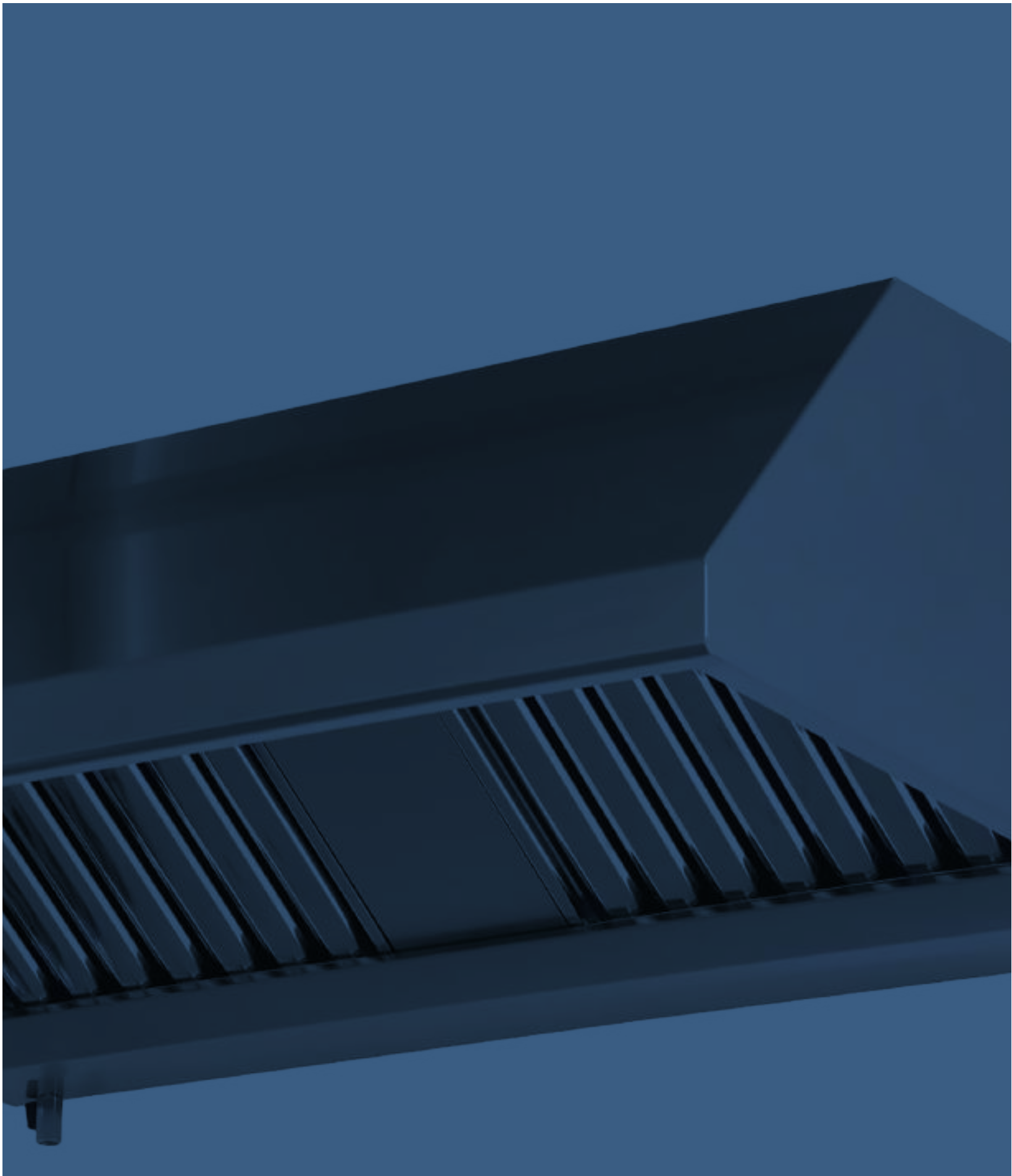

ZIDNE NAPE GABBIANO LINE

WALL HOODS GABBIANO LINE

Nape ove serije dizajnirane su i izrađene za korištenje u bilo kojem kuhinjskom okruženju, čak i u malim dimenzijama. Poseban profil čini ga prikladnim za korištenje za sve glavne blokove za kuhanje na zidu. U potpunosti izrađen od nehrđajućeg čelika AISI 304 sa scotch brite završnom obradom. Sastavljeno potpunim zavarivanjem spojeva, s presavijenim rubovima čak i u unutarnjim dijelovima. Kanal za skupljanje kondenzata s odvodnom slavinom od 1/2", labirint filteri od nehrđajućeg čelika. Ovisno na modelu, nape ove serije mogu biti opremljene električnim ventilatorom, integriranim osvjetljenjem i regulatorom brzine.

The hoods of this series have been designed and built to be used in any kitchen environment, even in small dimensions. The particular profile makes it suitable to be used for all the main cooking blocks on the wall. Entirely made of AISI 304 stainless steel with scotch brite finish. Assembled by fully welding of the joints, with edges folded even in the internal parts. Condensate collecting duct with 1/2 "drain tap. Stainless steel labyrinth filters. Depending on the model, the hoods of this series can be equipped with an electric fan, integrated lighting and speed regulator.

GABBIANO LINE ZIDNE NAPE

Serie 70 / 90 / 110 / 130

GABBIANO LINE WALL HOODS



KONSTRUKCIJSKE KARAKTERISTIKE:

Tradicionalna linija zidne klasične nape omogućuje da se koristi u svakoj kuhinji, koliko god mala bila. Konstrukcija od AISI 304. Posebna izrada na zahtjev.

ISPORUČENO:

- Labirint filtri
- Slavina za ispuštanje kondenzata 1/2"
- Ostale duljine

BILJEŠKE:

Za pribor pogledajte odgovarajuće stranice.
Pakiranje u stretch foliju

CONSTRUCTION CHARACTERISTICS:

The traditional line of the wall mounted classic hood allows it to be used in any kitchen, however small. Construction in AISI 304. Special fabrication on request.

SUPPLIED:

- Baffle filters
- Condensate draining cock 1/2"
- Other lengths

NOTES:

For the accessories please see the relative pages. Pluriball wrap packaging with polystyrene corners included.

Prosječna brzina protoka definirana brzinom prolaza ispod haube 0,35m/s.
Average flow rate defined with passage speed under the hood 0.35m/sec.

FILTERI/FILTERS:

a (400x400) - b (500x400)
c (400x500) - d (500x500)

ZIDNE NAPE GABBIANO LINE • WALL HOODS GABBIANO LINE

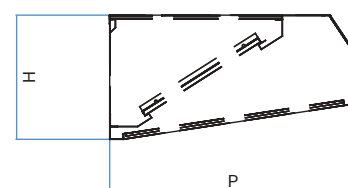
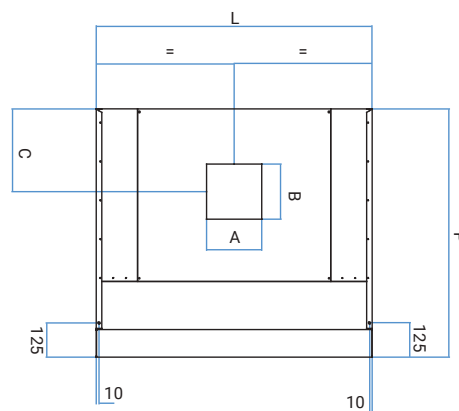
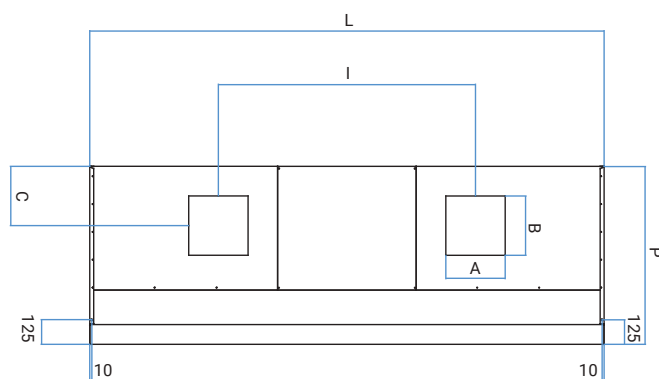

Serie 70

Modeli Models	304 €	Dim. PxLxh mm	AxB mm	C mm	Filteri n° Filters n°	Težina Kg Weight Kg	Vol. MC/H*	I mm	LED €
GP 7/10	798,70	700x1000x450	200x200	250	2a	26	900		143,50
GP 7/12	883,40	700x1200x450	200x200	250	2b	30	1100		145,60
GP 7/14	931,70	700x1400x450	250x250	250	3a	34	1250		214,90
GP 7/16	1.017,10	700x1600x450	250x250	250	3a	37	1400		216,30
GP 7/18	1.089,20	700x1800x450	250x250	250	3b	40	1600		300,30
GP 7/20	1.185,80	700x2000x450	300x300	250	4a	44	1800		303,80
GP 7/22	1.274,70	700x2200x450	300x300	250	4a	46	1950		308,00
GP 7/24	1.363,60	700x2400x450	300x300	250	4b	48	2200		338,10
GP 7/26	1.441,30	700x2600x450	300x300	250	4b	51	2300		341,60
GP 7/28	1.539,30	700x2800x450	250x250x2	250	5b	54	2500	1400	343,00
GP 7/30	1.638,70	700x3000x450	250x250x2	250	5b	57	2700	1500	345,80
GP 7/32	1.736,70	700x3200x450	250x250x2	250	5b	61	2800	1600	460,60
GP 7/34	1.882,30	700x3400x450	300x300x2	250	6b	64	3000	1700	462,00
GP 7/36	2.025,10	700x3600x450	300x300x2	250	6b	67	3200	1800	464,10
GP 7/38	2.168,60	700x3800x450	300x300x2	250	6b	71	3350	1900	466,90

Serie 90

Modeli Models	304 €	Dim. PxLxh mm	AxB mm	C mm	Filteri n° Filters n°	Težina Kg Weight Kg	Vol. MC/H*	I mm	LED €
GP 9/10	883,40	900x1000x450	200x200	300	2c	28	1100		159,60
GP 9/12	931,70	900x1200x450	200x200	300	2d	30	1400		163,10
GP 9/14	1.017,10	900x1400x450	250x250	300	3c	35	1650		231,00
GP 9/16	1.089,20	900x1600x450	300x300	300	3c	38	1400		233,80
GP 9/18	1.185,80	900x1800x450	300x300	300	3d	40	2000		317,10
GP 9/20	1.274,70	900x2000x450	300x300	300	4c	46	2250		319,20
GP 9/22	1.363,60	900x2200x450	300x300	300	4c	49	2500		324,80
GP 9/24	1.441,30	900x2400x450	300x300	300	4d	52	2700		354,20
GP 9/26	1.539,30	900x2600x450	300x300x2	300	4d	55	2950	1300	357,70
GP 9/28	1.638,70	900x2800x450	300x300x2	300	5d	60	3200	1400	359,80
GP 9/30	1.719,90	900x3000x450	300x300x2	300	5d	64	3400	1500	361,90
GP 9/32	1.807,40	900x3200x450	300x300x2	300	5d	67	3650	1600	476,00
GP 9/34	1.913,10	900x3400x450	300x300x2	300	6d	70	3850	1700	478,80
GP 9/36	2.025,10	900x3600x450	300x300x2	300	6d	74	4050	1800	480,20

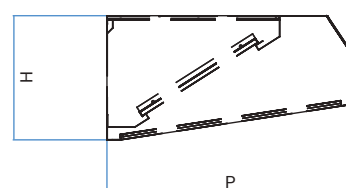
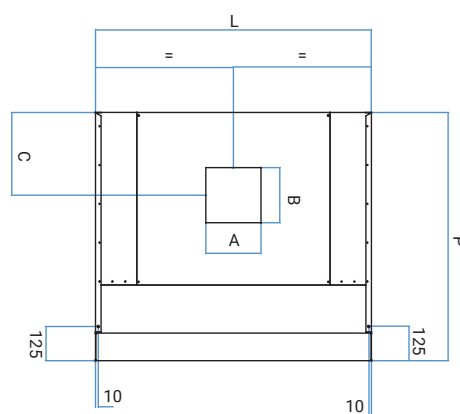
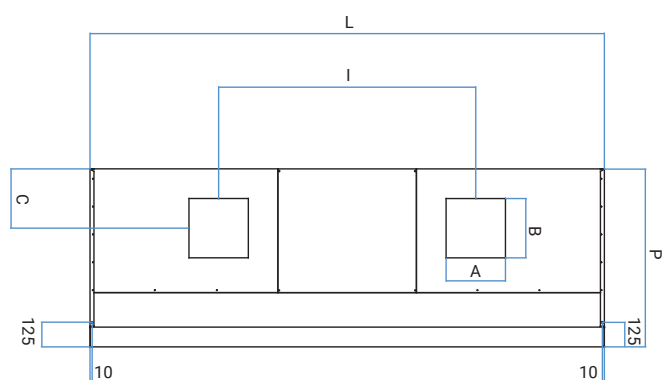

Serie 110

Modeli Models	304 €	Dim. PxLxh mm	AxB mm	C mm	Filteri n° FilterP n°	Težina Kg Weight Kg	Vol. MC/H*	I mm	LED €
GP 11/10	931,70	1100x1000x450	200x200	300	2c	35	1400		175,70
GP 11/12	989,10	1100x1200x450	250x250	300	2d	38	1700		178,50
GP 11/14	1.075,20	1100x1400x450	250x250	300	3c	41	1950		247,80
GP 11/16	1.160,60	1100x1600x450	300x300	300	3c	44	2200		249,90
GP 11/18	1.260,00	1100x1800x450	300x300	300	3d	47	2500		333,90
GP 11/20	1.358,00	1100x2000x450	300x300	300	4c	50	2800		336,00
GP 11/22	1.445,50	1100x2200x450	300x300	300	4c	53	3100		341,60
GP 11/24	1.532,30	1100x2400x450	300x300x2	300	4d	56	3400	1200	371,70
GP 11/26	1.638,00	1100x2600x450	300x300x2	300	4d	59	3600	1300	373,10
GP 11/28	1.740,20	1100x2800x450	300x300x2	300	5d	62	3900	1400	376,60
GP 11/30	1.829,10	1100x3000x450	300x300x2	300	5d	65	4200	1500	378,70
GP 11/32	1.919,40	1100x3200x450	300x300x2	300	5d	68	4500	1600	492,10
GP 11/34	2.002,70	1100x3400x450	300x300x2	300	6d	73	4700	1700	494,20
GP 11/36	2.134,30	1100x3600x450	300x300x2	300	6d	78	5000	1800	497,70
GP 11/38	2.209,20	1100x3800x450	300x300x2	300	6d	83	5300	1900	499,10

Serie 130

Modeli Models	304 €	Dim. PxLxh mm	AxB mm	C mm	Filteri n° Filters n°	Težina Kg Weight Kg	Vol. MC/H*	I mm	LED €
GP 13/12	1.033,20	1300x1200x450	250x250	300	2d	39	1700		178,50
GP 13/14	1.122,10	1300x1400x450	250x250	300	3c	42	1950		247,80
GP 13/16	1.212,40	1300x1600x450	300x250	300	3c	45	2200		249,90
GP 13/18	1.317,40	1300x1800x450	300x250	300	3d	48	2500		333,90
GP 13/20	1.422,40	1300x2000x450	300x300	300	4c	52	2800		336,00
GP 13/22	1.514,10	1300x2200x450	300x300	300	4c	56	3100		341,60
GP 13/24	1.604,40	1300x2400x450	300x300x2	300	4d	60	3400	1200	371,70
GP 13/26	1.714,30	1300x2600x450	300x300x2	300	4d	63	3600	1300	373,10
GP 13/28	1.824,20	1300x2800x450	300x300x2	300	5d	66	3900	1400	376,60
GP 13/30	1.919,40	1300x3000x450	300x300x2	300	5d	71	4200	1500	378,70
GP 13/32	2.048,20	1300x3200x450	300x300x2	300	5d	75	4500	1600	492,10
GP 13/34	2.117,50	1300x3400x450	300x300x2	300	6d	83	4700	1700	494,20
GP 13/36	2.233,00	1300x3600x450	300x300x2	300	6d	87	5000	1800	497,70
GP 13/38	2.299,50	1300x3800x450	300x300x2	300	6d	90	5300	1900	499,10

CENTRALNE NAPE GABBIANO LINE

ISLAND HOODS GABBIANO LINE

Nape ove serije dizajnirane su i izrađene za korištenje u bilo kojem kuhinjskom okruženju, čak i u slučaju niskih stropova. Poseban profil ga čini pogodnim za korištenje za centralno postavljene blokove za kuhanje. U potpunosti izrađen od nehrđajućeg čelika AISI 304 sa scotch brite završnom obradom. Sastavljeno potpunim zavarivanjem spojeva, s presavijenim rubovima čak iu unutarnjim dijelovima. Kanal za skupljanje kondenzata s odvodnom slavicom od 1/2", labirint filteri od nehrđajućeg čelika. Ovisno o modelu, nape ove serije mogu biti opremljene električnim ventilatorom, integriranim osvjetljenjem i regulatorom brzine.

The hoods of this series have been designed and built to be used in any kitchen environment, even in the case of low ceilings. The particular profile makes it suitable to be used for centrally positioned cooking blocks. Entirely made of AISI 304 stainless steel with scotch brite finish. Assembled by fully welding of the joints, with edges folded even in the internal parts. Condensate collecting duct with 1/2 "drain tap. Stainless steel labyrinth filters. Depending on the model, the hoods of this series can be equipped with an electric fan, integrated lighting and speed regulator.

CENTRALNE NAPE GABBIANO

LINE BEZ MOTORA

Serie 140 / 180 / 220

GABBIANO LINE ISLAND HOODS
WITHOUT EXTRACTOR FAN

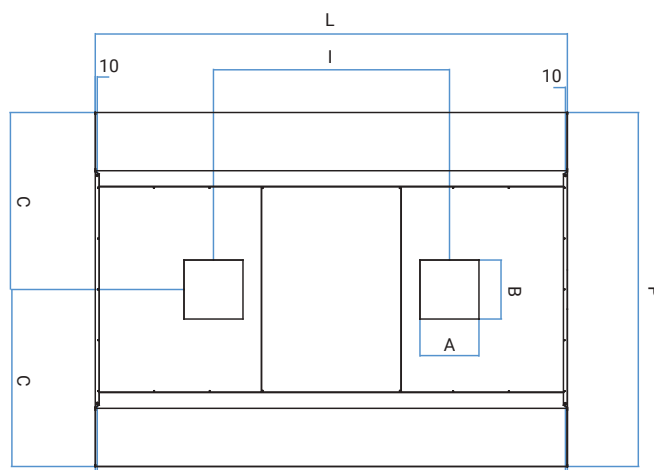
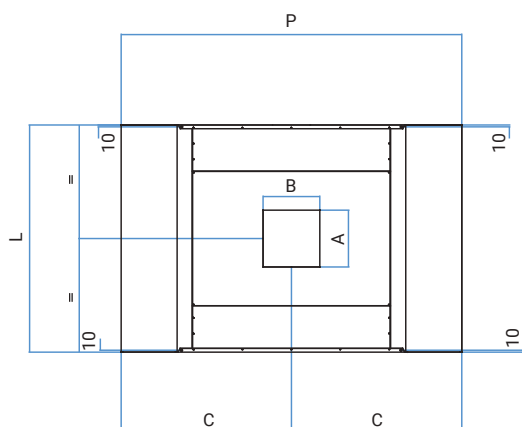
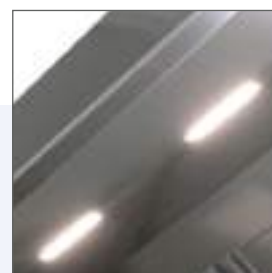

SREDIŠNJE NAPE GABBIANO LINE • ISLAND HOODS GABBIANO LINE

Serie 140

Modeli Models	304 €	Dim. PxLxh mm	AxB mm	C mm	Filteri n° Filters n°	Težina Kg Weight Kg	Vol. MC/H*	I mm	LED €
GC 14/12	1.200,50	1400x1200x450	250x250	700	4b	60	2100		290,50
GC 14/14	1.250,20	1400x1400x450	250x250	700	4b	64	2500		429,80
GC 14/16	1.367,10	1400x1600x450	300x300	700	6a	68	2800		434,00
GC 14/18	1.462,30	1400x1800x450	300x300	700	6b	72	3200		601,30
GC 14/20	1.526,70	1400x2000x450	300x300	700	8a	76	3500		606,20
GC 14/22	1.638,70	1400x2200x450	400x300	700	8a	80	3900		616,00
GC 14/24	1.751,40	1400x2400x450	400x300	700	8b	84	4200		676,90
GC 14/26	1.837,50	1400x2600x450	400x300	700	8b	88	4600		683,20
GC 14/28	1.904,70	1400x2800x450	300x300	700	10b	92	4900		686,70
GC 14/30	2.067,80	1400x3000x450	300x300x2	700	10b	96	5300	1500	692,30
GC 14/32	2.167,20	1400x3200x450	300x300x2	700	10b	100	5600	1600	920,50
GC 14/34	2.312,80	1400x3400x450	300x300x2	700	12b	104	6000	1700	924,70
GC 14/36	2.402,40	1400x3600x450	300x300x2	700	12b	108	6400	1800	928,20
GC 14/38	2.452,10	1400x3800x450	300x300x2	700	12b	120	6700	1900	933,80

KONSTRUKCIJSKE KARAKTERISTIKE:

Poseban profil čini ga idealnim za blokove za kuhanje 70 / 90 postavljene iznad otoka, čak i s niskim stropovima. Izrada od AISI 304. Posebna izrada na zahtjev.

ISPORUČENO:

- Labirint filtri
- Slavina za ispuštanje kondenzata 1/2"
- Ostale duljine

BILJEŠKE:

Za pribor pogledajte odgovarajuće stranice. Pakiranje u stretch foliju

Serie 180

Modeli Models	304 €	Dim. PxLxh mm	AxB mm	C mm	Filteri n° Filters n°	Težina Kg Weight Kg	Vol. MC/H*	I mm	LED €
GC 18/12	1.305,50	1800x1200x450	250x250	900	4d	64	2100		324,80
GC 18/14	1.407,70	1800x1400x450	300x300	900	4c	68	2500		462,00
GC 18/16	1.519,00	1800x1600x450	300x300	900	6c	72	2800		467,60
GC 18/18	1.612,10	1800x1800x450	300x300	900	6d	76	3200		634,90
GC 18/20	1.716,40	1800x2000x450	300x300	900	8c	80	3500		639,10
GC 18/22	1.828,40	1800x2200x450	400x300	900	8c	84	3950		650,30
GC 18/24	1.914,50	1800x2400x450	400x300x2	900	8d	88	4200		709,10
GC 18/26	2.062,90	1800x2600x450	300x300x2	900	8d	92	4600	1300	714,70
GC 18/28	2.179,10	1800x2800x450	300x300x2	900	10d	96	4900	1400	718,20
GC 18/30	2.291,10	1800x3000x450	300x300x2	900	10d	100	5300	1500	724,50
GC 18/32	2.418,50	1800x3200x450	300x300x2	900	10d	106	5600	1600	952,70
GC 18/34	2.457,70	1800x3400x450	300x300x2	900	12d	112	6000	1700	956,20
GC 18/36	2.693,60	1800x3600x450	300x300x2	900	12d	116	6400	1800	960,40
GC 18/38	2.742,60	1800x3800x450	300x300x2	900	12d	123	6700	1900	966,00

CONSTRUCTION CHARACTERISTICS:

The special profile makes it ideal for cooking blocks 70/90 positioned over islands, even with low ceilings. Construction in AISI 304.

Special fabrication on request.

SUPPLIED:

- Baffle filters
- Condensate draining cock 1/2"
- Other lengths

NOTES:

For the accessories please see the relative pages. Pluriball wrap packaging with polystyrene corners included.

Serie 220

Modeli Models	304 €	Dim. PxLxh mm	AxB mm	C mm	Filteri n° Filters n°	Težina Kg Weight Kg	Vol. MC/H*	I mm	LED €
GC 22/12	1.512,00	2200x1200x500	300x300	1100	4d	71	2100		357,70
GC 22/14	1.621,20	2200x1400x500	300x300	1100	4c	75	2500		494,20
GC 22/16	1.740,90	2200x1600x500	400x300	1100	6c	73	2800		500,50
GC 22/18	1.864,80	2200x1800x500	400x300	1100	6d	83	3200		667,80
GC 22/20	1.987,30	2200x2000x500	400x300	1100	8c	87	3500		673,40
GC 22/22	2.114,70	2200x2200x500	400x300	1100	8c	91	3950		683,20
GC 22/24	2.242,80	2200x2400x500	300x300x2	1100	8d	96	4200	1200	743,40
GC 22/26	2.329,60	2200x2600x500	300x300x2	1100	8d	101	4600	1300	747,60
GC 22/28	2.424,10	2200x2800x500	300x300x2	1100	10d	106	4900	1400	753,20
GC 22/30	2.550,80	2200x3000x500	400x300x2	1100	10d	110	5300	1500	757,40
GC 22/32	2.643,90	2200x3200x500	400x300x2	1100	10d	115	5600	1600	984,90
GC 22/34	2.732,80	2200x3400x500	400x300x2	1100	12d	120	6000	1700	989,10
GC 22/36	2.937,90	2200x3600x500	400x300x2	1100	12d	125	6400	1800	994,00
GC 22/38	3.035,90	2200x3800x500	400x300x2	1100	12d	130	6700	1900	998,90

Prosječna brzina protoka definirana brzinom prolaza ispod haube 0,35m/s. Average flow rate defined with passage speed under the hood 0.35m/sec.

FILTERI/FILTERS:

- a (400x400) - b (500x400)
- c (400x500) - d (500x500)

PRAVOKUTNE ZIDNE NAPE

CUBIC WALL HOODS

Nape ove serije s pravokutnim profilom dizajnirane su i izrađene kako bi se postiglo bolje zadržavanje dima i njihovo bolje izbacivanje. U potpunosti izrađen od nehrđajućeg čelika AISI 304 sa scotch brite završnom obradom. Sastavljeno potpunim zavarivanjem spojeva, s ravnomjerno presavijenim rubovima u unutarnjim dijelovima. Kanal za skupljanje kondenzata s odvodnom slavinom od 1/2", labirint filteri od nehrđajućeg čelika. Ovisno o modelu, nape ove serije mogu biti opremljene električnim ventilatorom, integriranim osvjetljenjem i regulatorom brzine.

The hoods of this series with a parallelepiped profile have been designed and built to achieve greater containment of the fumes and their better expulsion. Entirely made of AISI 304 stainless steel with scotch brite finish. Assembled by fully welding of the joints, with edges folded even in the internal parts. Condensate collecting duct with 1/2" drain tap. Stainless steel labyrinth filters. Depending on the model, the hoods of this series can be equipped with an electric fan, integrated lighting and speed regulator.

PRAVOKUTNE ZIDNE NAPE

Serie 90 / 110 / 230

WALL HOODS KUBIK LINE

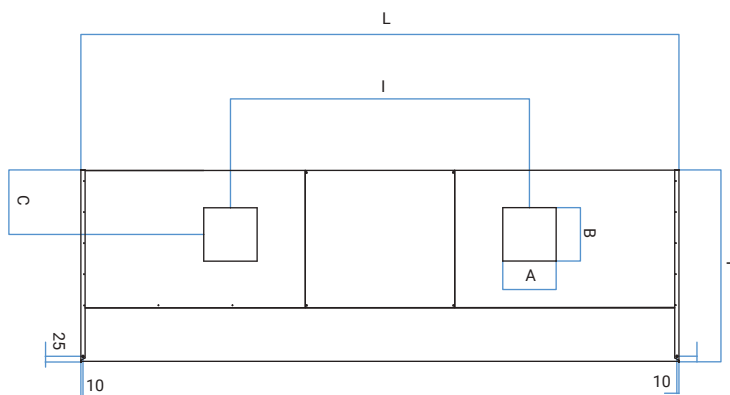
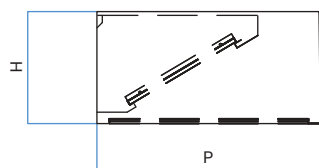

Serie 90

Modeli Models	304 €	Dim. PxLxh mm	AxB mm	C mm	Filteri n° Filters n°	Težina Kg Weight Kg	Vol. MC/H*	I mm	LED €
KP 9/10	883,40	900x1000x450	200x200	300	2c	32	1100		179,90
KP 9/12	931,70	900x1200x450	200x200	300	2d	35	1400		190,40
KP 9/14	1.016,40	900x1400x450	250x250	300	3c	38	1600		267,40
KP 9/16	1.089,90	900x1600x450	300x300	300	3c	41	1800		278,60
KP 9/18	1.185,80	900x1800x450	300x300	300	3d	44	2000		371,00
KP 9/20	1.274,70	900x2000x450	300x300	300	4c	48	2250		382,20
KP 9/22	1.363,60	900x2200x450	300x300	300	4c	50	2500		392,70
KP 9/24	1.441,30	900x2400x450	300x300	300	4d	54	2700		429,10
KP 9/26	1.539,30	900x2600x450	300x300x2	300	4d	57	2950	1300	440,30
KP 9/28	1.638,00	900x2800x450	300x300x2	300	5d	60	3200	1400	451,50
KP 9/30	1.719,90	900x3000x450	300x300x2	300	5d	63	3400	1500	462,00
KP 9/32	1.801,10	900x3200x450	300x300x2	300	5d	67	3650	1600	585,90
KP 9/34	1.867,60	900x3400x450	300x300x2	300	6d	69	3850	1700	597,10
KP 9/36	1.974,00	900x3600x450	300x300x2	300	6d	72	4100	1800	607,60
KP 9/38	2.030,00	900x3800x450	300x300x2	300	6d	79	4300	1900	618,10

KONSTRUKCIJSKE KARAKTERISTIKE:

Paralelepipedni profil omogućuje bolju kontrolu i odvod dima uz zadržavanje estetike linije tehnoloških napa. Izrada od AISI 304. Posebna izrada na zahtjev.

ISPORUČENO:

- Labirint filtri
- Slavina za ispuštanje kondenzata 1/2"
- Ostale duljine

BILJEŠKE:

Za pribor pogledajte odgovarajuće stranice. Pakiranje u stretch foliju

Serie 110

Modeli Models	304 €	Dim. PxLxh mm	AxB mm	C mm	Filteri n° Filters n°	Težina Kg Weight Kg	Vol. MC/H*	I mm	LED €
KP 11/12	989,10	1100x1200x450	250x250	300	2d	37	1700		207,20
KP 11/14	1.075,20	1100x1400x450	250x250	300	3c	40	1950		287,00
KP 11/16	1.160,60	1100x1600x450	300x300	300	3c	43	2200		300,30
KP 11/18	1.260,00	1100x1800x450	300x300	300	3d	46	2500		392,70
KP 11/20	1.358,70	1100x2000x450	300x300	300	4c	50	2800		405,30
KP 11/22	1.445,50	1100x2200x450	300x300	300	4c	54	3100		420,00
KP 11/24	1.533,00	1100x2400x450	300x300x2	300	4d	58	3400	1300	459,90
KP 11/26	1.637,30	1100x2600x450	300x300x2	300	4d	61	3600	1300	473,20
KP 11/28	1.740,20	1100x2800x450	300x300x2	300	5d	64	3900	1400	486,50
KP 11/30	1.829,10	1100x3000x450	300x300x2	300	5d	67	4200	1500	499,80
KP 11/32	1.919,40	1100x3200x450	300x300x2	300	5d	71	4500	1600	626,50
KP 11/34	1.987,30	1100x3400x450	300x300x2	300	6d	74	4700	1700	639,80
KP 11/36	2.133,60	1100x3600x450	300x300x2	300	6d	77	5000	1800	652,40
KP 11/38	2.196,60	1100x3800x450	300x300x2	300	6d	85	5300	1900	665,70

CONSTRUCTION CHARACTERISTICS:

The special profile makes it ideal for cooking blocks 70/90 positioned over islands, even with low ceilings. Construction in AISI 304. Special fabrication on request.

SUPPLIED:

- Baffle filters
- Condensate draining cock 1/2"
- Other lengths

NOTES:

For the accessories please see the relative pages. Pluriball wrap packaging with polystyrene corners included.

Serie 130

Modeli Models	304 €	Dim. PxLxh mm	AxB mm	C mm	Filteri n° Filters n°	Težina Kg Weight Kg	Vol. MC/H*	I mm	LED €
KP 13/12	1.066,10	1300x1200x450	250x250	300	2d	39	2100		228,90
KP 13/14	1.157,10	1300x1400x450	250x250	300	3c	42	2500		312,20
KP 13/16	1.250,20	1300x1600x450	300x300	300	3c	45	2800		328,30
KP 13/18	1.358,70	1300x1800x450	300x300	300	3d	48	3200		424,20
KP 13/20	1.465,80	1300x2000x450	300x300	300	4c	52	3500		440,30
KP 13/22	1.561,00	1300x2200x450	300x300	300	4c	57	3900		456,40
KP 13/24	1.653,40	1300x2400x450	300x300x2	300	4d	60	4200	2300	499,80
KP 13/26	1.767,50	1300x2600x450	300x300x2	300	4d	62	4600	1300	516,60
KP 13/28	1.879,50	1300x2800x450	300x300x2	300	5d	66	4900	1400	532,70
KP 13/30	1.974,00	1300x3000x450	300x300x2	300	5d	71	5300	1500	549,50
KP 13/32	2.134,30	1300x3200x450	300x300x2	300	5d	75	5600	1600	679,00
KP 13/34	2.181,90	1300x3400x450	300x300x2	300	6d	79	6000	1700	700,70
KP 13/36	2.337,30	1300x3600x450	300x300x2	300	6d	83	6400	1800	711,90
KP 13/38	2.407,30	1300x3800x450	300x300x2	300	6d	90	6700	1900	728,00

Prosječna brzina protoka definirana brzinom prolaza ispod haube 0,35m/s. Average flow rate defined with passage speed under the hood 0.35m/sec.

FILTERI/FILTERS:

- a (400x400) - b (500x400)
- c (400x500) - d (500x500)

PRAVOKUTNE CENTRALNE NAPE

CUBIC ISLAND HOODS

Nape ove serije s paralelopipednim profilom dizajnirane su i izrađene kako bi se postiglo bolje zadržavanje dima i njihovo bolje izbacivanje. U potpunosti izrađen od nehrđajućeg čelika AISI 304 sa scotch brite završnom obradom. Sastavljeno potpunim zavarivanjem spojeva, s ravnomjerno presavijenim rubovima u unutarnjim dijelovima. Kanal za skupljanje kondenzata s odvodnom slavinom od 1/2". Labirint filteri od nehrđajućeg čelika. Ovisno o modelu, nape ove serije mogu biti opremljene električnim ventilatorom, integriranim osvjetljenjem i regulatorom brzine.

The hoods of this series with a parallelepiped profile have been designed and built to achieve greater containment of the fumes and their better expulsion. Entirely made of AISI 304 stainless steel with scotch brite finish. Assembled by fully welding of the joints, with edges folded even in the internal parts. Condensate collecting duct with 1/2" drain tap. Stainless steel labyrinth filters. Depending on the model, the hoods of this series can be equipped with an electric fan, integrated lighting and speed regulator.

PRAVOKUTNE CENTRALNE NAPE

Serie 140 / 180 / 220

ISLANDS HOODS KUBIK LINE

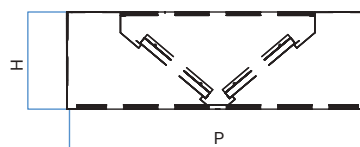
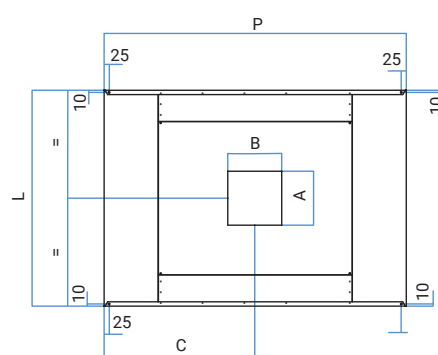
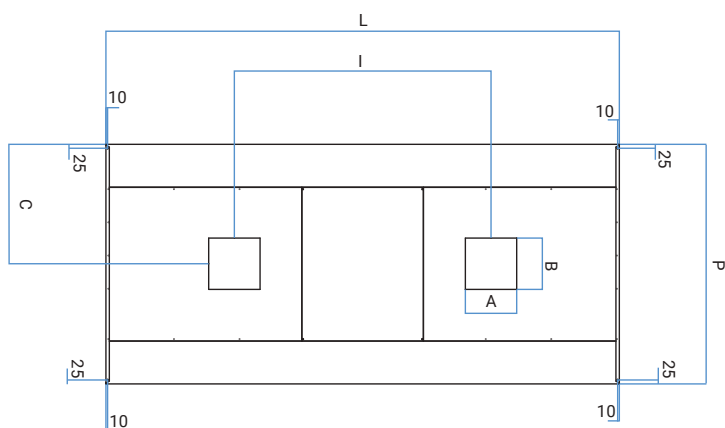

KOBIČAN CENTRALNE NAPE • CUBIC WALL HOODS

Serie 140

Modeli Models	304 €	Dim. PxLxh mm	AxB mm	Filteri n° Filters n°	Težina Kg Weight Kg	Vol. MC/H*	I mm	LED €
KC 14/12	1.180,90	1400x1200x450	250x250	4b	60	2100		331,10
KC 14/14	1.288,00	1400x1400x450	250x250	4b	64	2500		485,10
KC 14/16	1.390,20	1400x1600x450	300x300	6a	68	2800		507,50
KC 14/18	1.509,20	1400x1800x450	300x300	6b	72	3200		692,30
KC 14/20	1.654,10	1400x2000x450	300x300	8a	76	3500		714,70
KC 14/22	1.730,40	1400x2200x450	400x300	8a	80	3900		735,70
KC 14/24	1.823,50	1400x2400x450	400x300	8b	84	4200		808,50
KC 14/26	1.910,30	1400x2600x450	400x300	8b	88	4600		830,90
KC 14/28	2.038,40	1400x2800x450	300x300	10b	92	4900	1400	854,00
KC 14/30	2.104,20	1400x3000x450	300x300x2	10b	96	5300	1500	875,00
KC 14/32	2.338,70	1400x3200x450	300x300x2	10b	100	5600	1600	1.120,00
KC 14/34	2.467,50	1400x3400x450	300x300x2	12b	104	6000	1700	1.144,50
KC 14/36	2.542,40	1400x3600x450	300x300x2	12b	108	6400	1800	1.165,50
KC 14/38	2.620,10	1400x3800x450	300x300x2	12b	120	6700	1900	1.186,50

KONSTRUKCIJSKE KARAKTERISTIKE:

Paralelepipedni profil omogućuje bolju kontrolu i odvod dima uz zadržavanje estetike linije tehnoloških napa. Izrada od AISI 304. Posebna izrada na zahtjev.

ISPORUČENO:

- Labirint filtri
- Slavina za ispuštanje kondenzata 1/2"
- Ostale duljine

BILJEŠKE:

Za pribor pogledajte odgovarajuće stranice. Pakiranje u stretch foliji

Serie 180

Modeli Models	304 €	Dim. PxLxh mm	AxB mm	Filteri n° Filters n°	Težina Kg Weight Kg	Vol. MC/H*	I mm	LED €
KC 18/12	1.353,10	1800x1200x450	300x300	4d	64	2750		255,00
KC 18/14	1.459,50	1800x1400x450	300x300	6c	68	3200		354,00
KC 18/16	1.574,30	1800x1600x450	300x300	6c	72	3650		357,00
KC 18/18	1.672,30	1800x1800x450	400x300	6d	76	4050		477,00
KC 18/20	1.802,50	1800x2000x450	400x300	8c	80	4550		480,00
KC 18/22	1.945,30	1800x2200x450	400x300	8c	84	5000		488,00
KC 18/24	2.012,50	1800x2400x450	300x300x2	8d	88	5450	1200	531,00
KC 18/26	2.141,30	1800x2600x450	300x300x2	8d	92	5900	1300	533,00
KC 18/28	2.263,80	1800x2800x450	300x300x2	10d	96	6350	1400	538,00
KC 18/30	2.377,20	1800x3000x450	300x300x2	10d	100	6800	1500	541,00
KC 18/32	2.634,80	1800x3200x450	300x300x2	10d	106	7250	1600	703,00
KC 18/34	2.810,50	1800x3400x450	300x300x2	12d	112	7700	1700	706,00
KC 18/36	2.970,10	1800x3600x450	400x300x2	12d	116	8200	1800	711,00
KC 18/38	3.094,00	1800x3800x450	400x300x2	12d	123	8600	1900	713,00

CONSTRUCTION CHARACTERISTICS:

The special profile makes it ideal for cooking blocks 70/90 positioned over islands, even with low ceilings. Construction in AISI 304. Special fabrication on request.

SUPPLIED:

- Baffle filters
- Condensate draining cock 1/2"
- Other lengths

NOTES:

For the accessories please see the relative pages. Pluriball wrap packaging with polystyrene corners included.

Serie 220

Modeli Models	304 €	Dim. PxLxh mm	AxB mm	Filteri n° Filters n°	Težina Kg Weight Kg	Vol. MC/H*	I mm	LED €
KC 22/12	1.568,70	2200x1200x500	300x300	4d	65	3300		414,40
KC 22/14	1.682,10	2200x1400x500	300x300	6c	72	3900		574,00
KC 22/16	1.805,30	2200x1600x500	400x300	6c	79	4450		600,60
KC 22/18	1.934,10	2200x1800x500	400x300	6d	82	5000		785,40
KC 22/20	2.060,10	2200x2000x500	400x300	8c	86	5550		809,90
KC 22/22	2.192,40	2200x2200x500	400x300	8c	90	6100		840,70
KC 22/24	2.324,70	2200x2400x500	300x300x2	8d	94	6650	1200	920,50
KC 22/26	2.417,10	2200x2600x500	300x300x2	8d	102	7200	1300	947,10
KC 22/28	2.566,20	2200x2800x500	300x300x2	10d	109	7800	1400	973,70
KC 22/30	2.722,30	2200x3000x500	400x300x2	10d	110	8300	1500	1000,30
KC 22/32	2.791,60	2200x3200x500	400x300x2	10d	112	8850	1600	1253,00
KC 22/34	2.961,00	2200x3400x500	400x300x2	12d	117	9450	1700	1279,60
KC 22/36	3.173,10	2200x3600x500	400x300x2	12d	120	10000	1800	1304,80
KC 22/38	3.256,40	2200x3800x500	400x300x2	12d	130	10500	1900	1331,40

Prosječna brzina protoka definirana brzinom prolaza ispod haube 0,35m/s. Average flow rate defined with passage speed under the hood 0.35m/sec.

FILTERI/FILTERS:

- a (400x400) - b (500x400)
- c (400x500) - d (500x500)

KOMPENZACIJSKE NAPE

COMPENSATION HOODS (ECO)

Nape ove serije dizajnirane su i izrađene kako bi jamčile smanjenu depresiju prostorije s posljedičnim smanjenjem troškova klimatizacije. Zahvaljujući induktivnom učinku bolje skupljaju dim. Monoblok ili modularna kompenzacijska konstrukcija. U potpunosti izrađen od nehrđajućeg čelika AISI 304 sa scotch brite završnom obradom. Sastavljeno potpunim zavarivanjem spojeva, s presavijenim rubovima čak iu unutarnjim dijelovima. Perimetralni kanal za skupljanje kondenzata s odvodnom slavinom od 1/2". Integrirana rasvjeta s LED modulima IP68. Labirintski filtri od nehrđajućeg čelika.

The hoods of this series have been designed and built to guarantee reduced room depression with consequent reduction in air conditioning costs. Thanks to the inductive effect they present a better fume collection. Monoblock or modular compensation construction. Entirely made of AISI 304 stainless steel with scotch brite finish. Assembled by fully welding of the joints, with edges folded even in the internal parts. Condensate collection perimeter duct with 1/2 "drain tap. Integrated lighting with LED modules IP68. Labyrinth filters in stainless steel.

ZIDNE KOMPENZACIJSKE NAPE

Serie 110 / 130 / 150

WALL COMPENSATION
HOODS KPR LINE

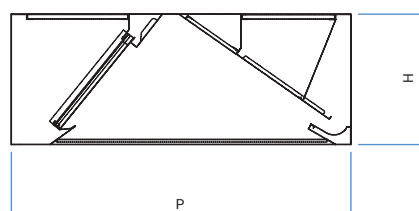
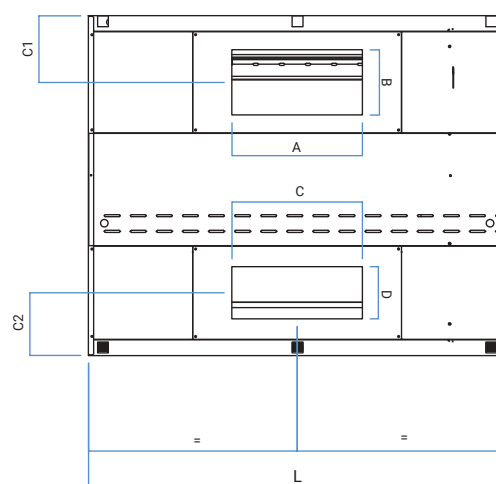
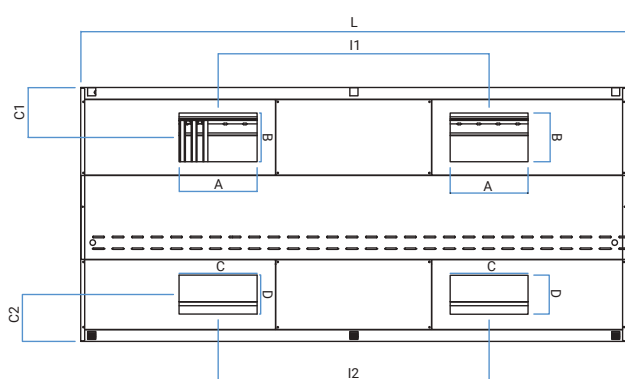
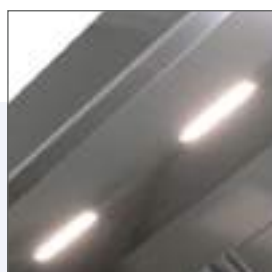

Serie 110

Modeli Models	304 €	Dim. PxLxh mm	AxB mm	CxD mm	c1 mm	c2 mm	l1 mm	l2 mm	Filteri n° Filters n°	Težina Kg Weight Kg	Vol. MC/H*
KPR 11/12	2.394,00	1100x1200x500	400x250	400x200	190	190			2d	49	1900
KPR 11/14	2.526,30	1100x1400x500	400x250	400x200	190	190			3c	56	2200
KPR 11/16	2.663,50	1100x1600x500	500x250	500x200	190	190			3c	61	2550
KPR 11/18	2.797,90	1100x1800x500	500x250	500x200	190	190			3d	68	2850
KPR 11/20	3.042,20	1100x2000x500	600x250	600x200	190	190			4c	74	3200
KPR 11/22	3.206,00	1100x2200x500	600x250	600x200	190	190			4c	81	3500
KPR 11/24	3.346,70	1100x2400x500	700x250	700x200	190	190			4d	87	3800
KPR 11/26	3.559,50	1100x2600x500	700x250	700x200	190	190			4d	94	4120
KPR 11/28	3.731,70	1100x2800x500	400x250x2	400x200x2	190	190	1400	1400	5d	100	4440
KPR 11/30	3.898,30	1100x3000x500	400x250x2	400x200x2	190	190	1500	1500	5d	107	4750
KPR 11/32	4.001,20	1100x3200x500	500x250x2	500x200x2	190	190	1600	1600	5d	113	5070
KPR 11/34	4.202,80	1100x3400x500	600x250x2	600x200x2	190	190	1700	1700	6d	120	5390
KPR 11/36	4.363,10	1100x3600x500	600x250x2	600x200x2	190	190	1800	1800	6d	124	5700
KPR 11/38	4.601,80	1100x3800x500	600x250x2	600x200x2	190	190	1900	1900	6d	133	6020

KONSTRUKCIJSKE KARAKTERISTIKE:

Napa s kompenziranom protokom, kroz ulaz zraka koji se šalje prema filterima, osigurava a smanjen negativni tlak okoline, s posljedičnim smanjenjem troškova klimatizacije i poboljšanjem odvoda dima zahvaljujući induktivnom učinku. Konstrukcija od nehrđajućeg čelika AISI 304. Posebna izrada na zahtjev.

ISPORUČENO:

- Labirint filteri
- Ugrađena LED svjetla
- Slavina za ispuštanje kondenzata 1/2"
- Ostale duljine

BILJEŠKE:

Za pribor pogledajte odgovarajuće stranice. Pakiranje u stretch foliju

Serie 130

Modeli Models	304 €	Dim. PxLxh mm	AxB mm	CxD mm	c1 mm	c2 mm	l1 mm	l2 mm	Filteri n° Filters n°	Težina Kg Weight Kg	Vol. MC/H*
KPR 13/12	2.452,80	1300x1200x500	400x250	400x200	240	240			2d	54	2250
KPR 13/14	2.638,30	1300x1400x500	400x250	400x200	240	240			3c	61	2620
KPR 13/16	2.797,90	1300x1600x500	500x250	500x200	240	240			3c	69	3000
KPR 13/18	2.958,20	1300x1800x500	500x250	500x200	240	240			3d	77	3370
KPR 13/20	3.164,00	1300x2000x500	600x250	600x200	240	240			4c	84	3770
KPR 13/22	3.283,00	1300x2200x500	600x250	600x200	240	240			4c	91	3750
KPR 13/24	3.486,70	1300x2400x500	700x250	700x200	240	240			4d	98	4120
KPR 13/26	3.629,50	1300x2600x500	700x250	700x200	240	240			4d	105	4500
KPR 13/28	3.852,80	1300x2800x500	400x250x2	400x200x2	240	240	1400	1400	5d	112	4870
KPR 13/30	4.126,50	1300x3000x500	400x250x2	400x200x2	240	240	1500	1500	5d	120	5250
KPR 13/32	4.269,30	1300x3200x500	500x250x2	500x200x2	240	240	1600	1600	5d	128	5990
KPR 13/34	4.387,60	1300x3400x500	600x250x2	600x200x2	240	240	1700	1700	6d	136	6370
KPR 13/36	4.516,40	1300x3600x500	600x250x2	600x200x2	240	240	1800	1800	6d	144	6740
KPR 13/38	4.692,10	1300x3800x500	600x250x2	600x200x2	240	240	1900	1900	6d	152	7120

CONSTRUCTION CHARACTERISTICS:

The hood with compensated flow, through air input sent towards the filters, ensures a reduced negative pressure of the environment, with consequent reduction in air conditioning costs and improvement of fume extraction thanks to the inductive effect. Construction in stainless steel AISI 304. Special fabrication on request.

SUPPLIED:

- Baffle filters
- Built-in LED lights
- Condensate draining cock 1/2"
- Other lengths

NOTES:

For the accessories please see the relative pages. Pluriball wrap packaging with polystyrene corners included.

Serie 150

Modeli Models	304 €	Dim. PxLxh mm	AxB mm	CxD mm	c1 mm	c2 mm	l1 mm	l2 mm	Filteri n° Filters n°	Težina Kg Weight Kg	Vol. MC/H*
KPR 15/12	2.606,80	1500x1200x500	400x250	400x200	290	290			2d	58	2600
KPR 15/14	2.781,80	1500x1400x500	400x250	400x200	290	290			3c	66	3030
KPR 15/16	2.959,60	1500x1600x500	500x250	500x200	290	290			3c	75	3460
KPR 15/18	3.154,90	1500x1800x500	500x250	500x200	290	290			3d	83	3890
KPR 15/20	3.476,20	1500x2000x500	600x250	600x200	290	290			4c	91	4320
KPR 15/22	3.544,80	1500x2200x500	600x250	600x200	290	290			4c	99	4750
KPR 15/24	3.586,10	1500x2400x500	700x250	700x200	290	290			4d	108	5200
KPR 15/26	3.799,60	1500x2600x500	700x250	700x200	290	290			4d	116	5620
KPR 15/28	3.981,60	1500x2800x500	400x250x2	400x200x2	290	290	1400	1400	5d	124	6050
KPR 15/30	4.250,40	1500x3000x500	400x250x2	400x200x2	290	290	1500	1500	5d	132	6480
KPR 15/32	4.405,10	1500x3200x500	500x250x2	500x200x2	290	290	1600	1600	5d	140	6910
KPR 15/34	4.545,10	1500x3400x500	600x250x2	600x200x2	290	290	1700	1700	6d	149	7350
KPR 15/36	4.683,00	1500x3600x500	600x250x2	600x200x2	290	290	1800	1800	6d	157	7780
KPR 15/38	4.953,90	1500x3800x500	600x250x2	600x200x2	290	290	1900	1900	6d	165	8210

Definirana prosječna brzina protoka s brzinom prolaza ispod haube 0,4 m/sec.
Defined average flow rate with under-hood passage speed 0,4 m/sec.

FILTERI/FILTERS:

- 450 x 400
- 450 x 500

CENTRALNE KOMPENZACIJSKE NAPE (ECO)

Serie 160 / 180 / 200

ISLAND COMPENSATION HOODS KCR LINE

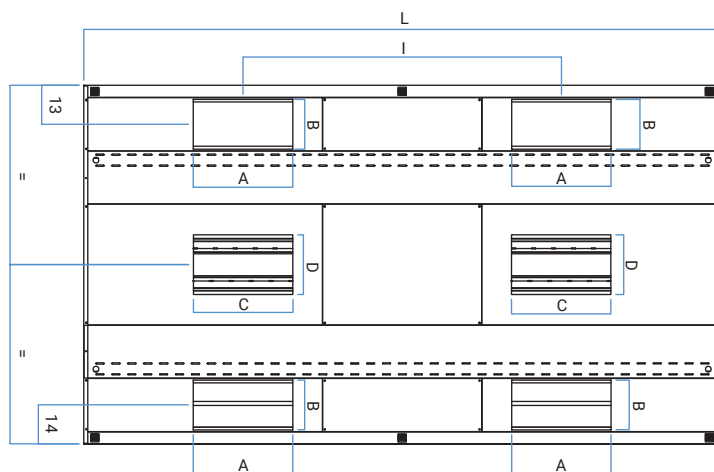
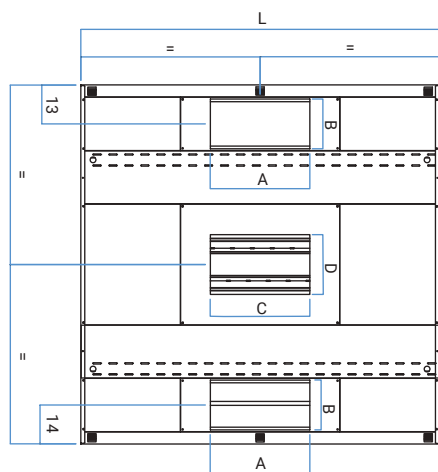
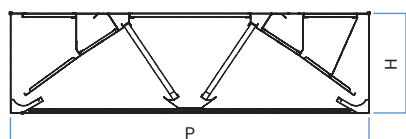

Serie 160

Modeli Models	304 €	Dim. PxLxh mm	AxB mm	CxD mm	I1 mm	I2 mm	Filteri n° Filters n°	Težina Kg Weight Kg	Vol. MC/H*
KCR 16/16	3.383,80	1600x1600x500	500x200	500x250			6a	118	3690
KCR 16/18	3.749,20	1600x1800x500	500x200	500x250			6b	130	4150
KCR 16/20	4.197,90	1600x2000x500	600x200	600x250			8a	156	4610
KCR 16/22	4.389,00	1600x2200x500	600x200	600x250			8a	169	5070
KCR 16/24	4.768,40	1600x2400x500	700x200	700x250			8b	182	5530
KCR 16/26	4.962,30	1600x2600x500	700x200	700x250			8b	195	6000
KCR 16/28	5.320,70	1600x2800x500	400x200x2	400x250x2	1400	1400	10b	208	6550
KCR 16/30	5.909,40	1600x3000x500	400x200x2	400x250x2	1500	1500	10b	220	6910
KCR 16/32	6.071,10	1600x3200x500	500x200x2	500x250x2	1600	1600	10b	236	7380
KCR 16/34	6.631,80	1600x3400x500	600x200x2	600x250x2	1700	1700	12b	250	7840
KCR 16/36	6.797,00	1600x3600x500	600x200x2	600x250x2	1800	1800	12b	268	8300
KCR 16/38	7.078,40	1600x3800x500	600x200x2	600x250x2	1900	1900	12b	282	8780

KONSTRUKCIJSKE KARAKTERISTIKE:

Napa s kompenziranim protokom, kroz ulaz zraka usmjerenog prema filterima, osigurava smanjen negativni tlak okoline, uz posljedično smanjenje troškova klimatizacije i poboljšanje odvoda dima zahvaljujući induktivnom učinku. Konstrukcija od nehrđajućeg čelika AISI 304. Posebna izrada na zahtjev.

ISPORUČENO:

- Labirint filteri
- Ugrađena LED svjetla
- Slavina za ispuštanje kondenzata 1/2"
- Ostale duljine

BILJEŠKE:

Za pribor pogledajte odgovarajuće stranice. Pakiranje s mjehurićima s uglovima od polistirena.

Serie 180

Modeli Models	304 €	Dim. PxLxh mm	AxB mm	CxD mm	I1 mm	I2 mm	Filteri n° Filters n°	Težina Kg Weight Kg	Vol. MC/H*
KCR 18/20	4.792,20	1800x2000x500	600x300	600x250			8a	162	5200
KCR 18/22	5.033,70	1800x2200x500	600x300	600x250			8a	175	5700
KCR 18/24	5.310,90	1800x2400x500	700x300	700x250			8b	188	6220
KCR 18/26	5.586,70	1800x2600x500	700x300	700x250			8b	202	6740
KCR 18/28	5.950,00	1800x2800x500	400x300x2	400x250x2	1400	1400	10b	214	7260
KCR 18/30	6.324,50	1800x3000x500	400x300x2	400x250x2	1500	1500	10b	228	7780
KCR 18/32	6.533,80	1800x3200x500	500x300x2	500x250x2	1600	1600	10b	240	8300
KCR 18/34	6.988,10	1800x3400x500	600x300x2	600x250x2	1700	1700	12b	253	8810
KCR 18/36	7.347,90	1800x3600x500	600x300x2	600x250x2	1800	1800	12b	266	9330
KCR 18/38	7.587,30	1800x3800x500	600x300x2	600x250x2	1900	1900	12b	285	9850

CONSTRUCTION CHARACTERISTICS:

The hood with compensated flow, through air input sent towards the filters, ensures a reduced negative pressure of the environment, with consequent reduction in air conditioning costs and improvement of fume extraction thanks to the inductive effect. Construction in stainless steel AISI 304. Special fabrication on request.

SUPPLIED:

- Baffle filters
- Built-in LED lights
- Condensate draining cock 1/2"
- Other lengths

NOTES:

For the accessories please see the relative pages. Pluriball wrap packaging with polystyrene corners included.

Serie 200

Modeli Models	304 €	Dim. PxLxh mm	AxB mm	CxD mm	I1 mm	I2 mm	Filteri n° Filters n°	Težina Kg Weight Kg	Vol. MC/H*
KCR 20/20	5.512,50	2000x2000x500	600x300	600x250			8c	170	5760
KCR 20/22	5.772,20	2000x2200x500	600x300	600x250			8c	183	6340
KCR 20/24	6.031,90	2000x2400x500	700x300	700x250			8d	207	6910
KCR 20/26	6.570,20	2000x2600x500	700x300	700x250			8d	210	7490
KCR 20/28	6.841,80	2000x2800x500	400x300x2	400x250x2	1400	1400	10d	222	8070
KCR 20/30	7.037,80	2000x3000x500	400x300x2	400x250x2	1500	1500	10d	263	8640
KCR 20/32	7.226,10	2000x3200x500	500x300x2	500x250x2	1600	1600	10d	248	9220
KCR 20/34	7.488,60	2000x3400x500	500x300x2	500x250x2	1700	1700	12d	265	9790
KCR 20/36	7.691,60	2000x3600x500	600x300x2	600x250x2	1800	1800	12d	274	10370
KCR 20/38	7.889,70	2000x3800x500	600x300x2	600x250x2	1900	1900	12d	293	10950

Definirana prosječna brzina protoka s brzinom prolaza ispod haube 0,4 m/sec.
Defined average flow rate with under-hood passage speed 0,4 m/sec.

FILTERI/FILTERS:

a (400x400) - b (500x400)
c (400x500) - d (500x500)

ZIDNE KOMPENZACIJSKE NAPE

Serie 220 / 260 / 300

WALL COMPENSATION
HOODS KCRD LINE

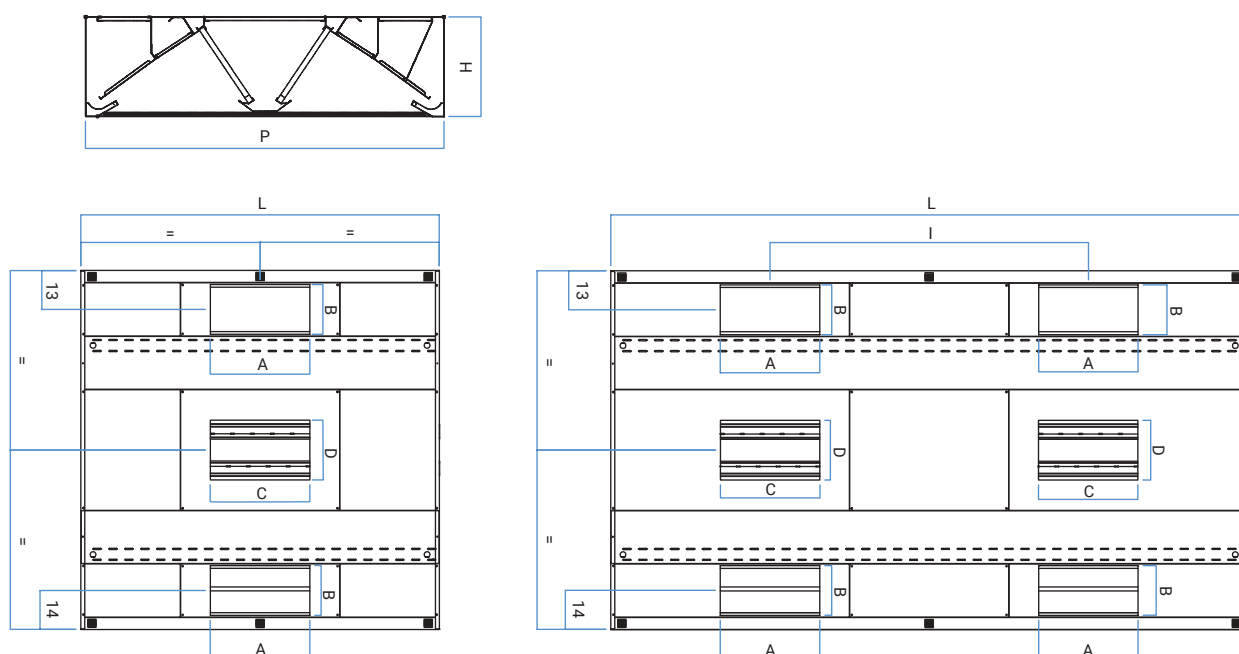
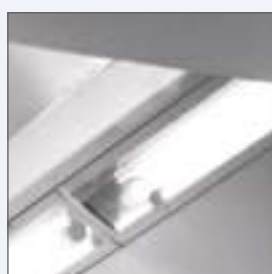

Serie 260

Modeli Models	304 €	Dim. PxLxh mm	AxB mm	CxD mm	I1 mm	I2 mm	Filteri n° Filters n°	Težina Kg Weight Kg	Vol. MC/H*
KCR-D 22/24	6.779,50	2200x2400x500	400x300x2	400x250x2			8d	312	7630
KCR-D 22/26	7.205,10	2200x2200x500	400x300x2	400x250x2			8d	334	8240
KCR-D 22/28	7.549,50	2200x2800x500	400x300x2	400x250x2	1400	1400	10d	356	8890
KCR-D 22/30	7.882,00	2200x3000x500	400x300x2	400x250x2	1500	1500	10d	375	9500
KCR-D 22/32	8.250,90	2200x3200x500	500x300x2	500x250x2	1600	1600	10d	390	10150
KCR-D 22/34	8.572,20	2200x3400x500	500x300x2	500x250x2	1700	1700	12d	418	10800
KCR-D 22/36	8.812,30	2200x3600x500	600x300x2	600x250x2	1800	1800	12d	434	11400
KCR-D 22/38	9.289,00	2200x3800x500	600x300x2	600x250x2	1900	1900	12d	475	12000

KONSTRUKCIJSKE KARAKTERISTIKE:

Modularna napa s kompenziranim protokom, kroz ulaz zraka usmjerenog prema filtrima, osigurava smanjen negativni tlak okoline, s posljedičnim smanjenjem troškova klimatizacije i poboljšanjem odvoda dima zahvaljujući in-dukativnom učinku. Konstrukcija od nehrđajućeg čelika AISI 304. Posebna izrada na zahtjev.

ISPORUČENO:

- Labirint filtri
- Ugrađena LED svjetla
- Slavina za ispuštanje kondenzata 1/2"
- Ostale duljine

BILJEŠKE:

Za pribor pogledajte odgovarajuće stranice. Pakiranje s mjehurićima s uglovima od polistirena.

Serie 260

Modeli Models	304 €	Dim. PxLxh mm	AxB mm	CxD mm	I1 mm	I2 mm	Filteri n° Filters n°	Težina Kg Weight Kg	Vol. MC/H*
KCR-D 26/24	7.067,90	2600x2400x500	400x300x2	700x250			8d	314	9000
KCR-D 26/26	7.343,70	2600x2600x500	400x300x2	700x250			8d	358	9750
KCR-D 26/28	7.791,00	2600x2800x500	400x300x2	400x250x2	1400	1400	10d	400	10500
KCR-D 26/30	8.338,40	2600x3000x500	400x300x2	400x250x2	1500	1500	10d	422	11200
KCR-D 26/32	8.624,00	2600x3200x500	500x300x2	500x250x2	1600	1600	10d	444	11980
KCR-D 26/34	8.775,90	2600x3400x500	500x300x2	500x250x2	1700	1700	12d	468	12740
KCR-D 26/36	9.118,20	2600x3600x500	600x300x2	600x250x2	1800	1800	12d	472	13500
KCR-D 26/38	9.384,20	2600x3800x500	600x300x2	600x250x2	1900	1900	12d	498	14250

CONSTRUCTION CHARACTERISTICS:

The hood with compensated flow, through air input sent towards the filters, ensures a reduced negative pressure of the environment, with consequent reduction in air conditioning costs and improvement of fume extraction thanks to the inductive effect. Construction in stainless steel AISI 304. Special fabrication on request.

SUPPLIED:

- Baffle filters
- Built-in LED lights
- Condensate draining cock 1/2"
- Other lengths

NOTES:

For the accessories please see the relative pages. Pluriball wrap packaging with polystyrene corners included.

Serie 300

Modeli Models	304 €	Dim. PxLxh mm	AxB mm	CxD mm	I1 mm	I2 mm	Filteri n° Filters n°	Težina Kg Weight Kg	Vol. MC/H*
KCR-D 30/24	7.393,40	3000x2400x500	400x300x2	700x250			8d	324	10350
KCR-D 30/30	7.696,50	3000x2600x500	400x300x2	700x250			8d	354	11200
KCR-D 30/28	8.059,10	3000x2800x500	400x300x2	400x250x2	1400	1400	10d	376	12090
KCR-D 30/30	8.699,60	3000x3000x500	400x300x2	400x250x2	1500	1500	10d	398	12960
KCR-D 30/32	8.962,10	3000x3200x500	500x300x2	500x250x2	1600	1600	10d	422	13800
KCR-D 30/34	9.270,10	3000x3400x500	500x300x2	500x250x2	1700	1700	12d	444	14680
KCR-D 30/36	9.530,50	3000x3600x500	600x300x2	600x250x2	1800	1800	12d	468	15550
KCR-D 30/38	9.997,40	3000x3800x500	600x300x2	600x250x2	1900	1900	12d	512	16400

Definirana prosječna brzina protoka s brzinom prolaza ispod haube 0,4 m/sec. Defined average flow rate with under-hood passage speed 0,4 m/sec.

FILTERI/FILTERS:

- 450 x 400
- 450 x 500

PRIRUČNIK ZA ASPIRACIJU

Aspiration manual

Kako odabrati jedinicu za ekstrakciju i najprikladniji proizvod

Svrha ovog izvješća je dati ideju o konceptima koji vam mogu pomoći da vidite kako implementirati jedinicu za ekstrakciju u kuhinji, također pokušavajući objasniti kako točno krenuti s odabirom uređaja. Prije svega moramo uzeti u obzir da svi proizvodi za velike kuhinje trebaju biti u skladu s određenim općim parametrima kao što su: lako čišćenje; dostupnost i sigurnost; izgrađen od nezapaljivih materijala.

Spisak

Kada razmišljamo o odsisnoj jedinici za kuhinju, prva stvar koju bismo trebali učiniti je pripremiti popis za provjeru koji uključuje sljedeće:

- 1. Naziv projekta, datum, grad**
- 2. Vrsta sustava:** novi, modificirani, prošireni ili bilo koji drugi
- 3. Vrsta sustava:** tradicionalna ekstrakcija, kompenzirani protok, s reintegriranom termo-ventilacijom, s eliminacijom dima i mirisa
- 4. Nape sa:** ugrađenim ventilatorom, rasvjetom, kompenziranim protokom, sustavom samopranja, protupožarnim sustavom (naznačiti je li i odvodni strop)
- 5. Ventilatorske jedinice:** zatvorena ili toranjska ekstrakcija, zatvoreni ulaz, termo-ventilacija, uklanjanje dima (naznačiti da li je od pocinčanog lima ili nehrđajućeg čelika)
- 6. Električne upravljačke ploče:** za ventilatorske jedinice (odvod-ulaz), za samoperuće nape, za termo-ventilaciju
- 7. Kanali:** od pocinčanog lima, nehrđajućeg čelika
- 8. Dimnjak:**
 - ako postoji, navedite unutarnji presjek i visinu kao i materijal od kojeg je izrađen
 - ako se mora izvesti, navesti da li u opeci, montažnim elementima ili limu
- 9. Montaža:** lokacija
- 10. Raspored:** priložite plan prostorije s naznačenim položajem za kuhanje i prostorima za pranje, položajem ventilatora, dimnjaka i svih obaveznih puteva.

Dimenzioniranje nape

Podsjećamo da:

- Napa bi uvijek trebala "stršiti" naprijed (DF) za najmanje 0,2-0,3 puta udaljenosti od donjeg ruba nape do ploče za kuhanje (DF = 0,2-0,3 H). Također bi trebao "stršiti" u stranu (DL) najmanje 0,3-0,4 puta udaljenosti H (DL = 0,3-0,4 H)

Primjer:

Napa postavljena 200 cm od tla sa pločom za kuhanje 90 cm od tla DF = 22-33 cm. DL = 33-44 cm.

Ova vrijednost strogo ovisi o tome koliko je površina za filtriranje blizu ploče za kuhanje. Stoga možemo reći da što je napa bliže ploči za kuhanje, to njene dimenzije mogu biti kompaktnije (Wall, Snack serija) i niže vrijednosti DF i DL.

- Kad god je napa uključena, u prostoriji se uvijek stvara vakuum koji može uzrokovati nelagodu uzrokovanu propuhom.

Također, napa ne samo da odvodi pare nego i toplinu, zbog čega iz naše ponude nudimo nape koje minimiziraju takve probleme reintegracijom dijela izvučenog zraka (nape s ulazom ili kompenzacijom), to sku ECO (ekonomične) nape.

How to choose an extraction unit and the most suitable products

The purpose of this report is to give an idea of the concepts that can help you see how to implement the extraction unit in the kitchen, also trying to explain exactly how to go about choosing the machines. First of all we have to consider that all products for big kitchens should comply with certain general parameters such as: easy cleaning; accessibility and safety; built with non-flammable materials.

Check-List

When we think about an extraction unit for the kitchen the first thing we should do is prepare a check-list that includes the following:

1. Name of the project, date, town
2. Type of system: new, modified, expanded or whatever else
3. Type of system: traditional extraction, compensated flow, with reintegrated thermo-ventilation, with elimination of fumes and odors
4. Hoods with: built-in fan, lighting, compensated flow, self-washing system, fire prevention system (indicate whether or not it is and extraction ceiling)
5. Fan units: shrouded or tower extraction, shrouded input, thermo-ventilation, elimination of fumes (indicate whether in galvanized sheet or stainless steel)
6. Electrical control panels: for fan units (extraction-input), for self-washing hoods, for thermo-ventilation
7. Ducting: in galvanized sheet, stainless steel
8. Flue:
 - if existing, specify the internal section and height as well as the material it's made of
 - if it has to be done, specify whether in brick, prefabricated elements or sheet
9. Assembly: specify whether to be done or not (masonry, electrical, plumbing and central heating works are not included in the assembly price)
10. Lay-out: enclose a plan of the room indicating the cooking position and washing areas, the position of the fans, flues and any compulsory paths.

Hood sizing

We remind you that:

- A hood should always "project" at the front (DF) by at least 0.2-0.3 times the distance from the bottom edge of the hood to the hob (DF = 0.2-0.3 H). It should also "project" sideways (DL) at least 0.3-0.4 times the distance H (DL = 0.3-0.4 H)

Example:

Hood installed 200 cm from the ground with the hob 90 cm from the ground: DF = 22-33 cm. DL = 33-44 cm.

This value depends strictly on the how near the filtering surface is to the hob.

We can therefore say that the closer the hood is to the hob the more compact its dimensions can be (Wall, Snack series) and the lower the DF and DL values can be.

- Whenever a hood is switched on, vacuum is always created inside the room which can give rise to discomfort caused by the draughts generated.

Also, the hood not only extracts fumes but also the heat which is why of our range offers hoods that minimize such problems by reintegrating part of the air extracted (hoods with input or compensation).

PRIRUČNIK ZA ASPIRACIJU

Aspiration manual

Određivanje protoka ekstrahiranog zraka

Postoje različiti načini za izračunavanje protoka zraka koji izvlači napa za velike kuhinje:

1. PREMA VRSTI APARATA

Odabirom ove metode moramo zbrojiti vrijednost maksimalnog protoka zraka za izvlačenje u mc/h, izdanu od strane svakog pojedinog stroja iz tog razloga pogledajte sljedeću tablicu koja daje takve vrijednosti.

TABLICA MAKSIMALNIH VRIJEDNOSTI PROTOKA ZRAKA U MC/H:

Pos.	Vrsta aparata	GAS mc/h	EL. mc/h
SERIE 700			
1	Friteza	1600	1300
2	Fry top	1600	1300
3	4 prstena	650	500
4	Marie kupka	250	200
5	Mangal	1000	800
6	Allplate	400	300
7	Okrugli lonac 40-60 lt	1500	1200
8	Lavastone roštilj	1750	1350
9	Salamander	-	200
SERIE 900			
10	Friteza	2000	1600
11	Fry top	2000	1600
12	4 prstena	800	650
13	Marie kupka	300	200
14	Mangal	1200	1000
15	Allplate	500	400
16	Četvrtasti lonac 100 lt	1800	1400
17	Okrugli lonac 150-200 lt	2000	1600
18	Lavastone roštilj	2200	1800
19	6 prstenova ili 6 ploča	1200	1000
20	8 prstenova ili 8 ploča	1600	1300
21	Kuhalo za tjesteninu	700	600
CENTRALI SERIES			
22	4 Prstena	900	800
23	6 Prstena	1350	1100
24	8 Prstena	1800	1500

Pos.	Vrsta aparata	GAS mc/h	EL. mc/h
OVENS			
25	Klasična pećnica sa 4 rešetke	1600	1300
26	Klasična pećnica sa 6 rešetki	1600	1300
27	Klasična pećnica sa 10 rešetki	650	500
28	Klasična pećnica sa 20 rešetki	250	200
29	Konvencionalna parna pećnica s 4 rešetke	1000	800
30	Konvencionalna parna pećnica s 10 rešetke	400	300
31	Konvencionalna parna pećnica s 20 rešetke	1500	1200
AUTOMATIC PASTA COOKERS			
32	Automatsko kuhalo za tjesteninu	2000	1600
VARIOUS			
33	Okretna friteza	900	800
34	Automatski roštilj	1350	1100
35	Podjela	1800	1500
36	Velika ploča za kuhanje	1800	1500
SAUCEPANS			
37	Okrugla posuda 100 lt	900	800
38	Okrugla posuda 200 lt	1350	1100
39	Okrugla posuda 300 lt	1800	1500
40	Okrugla posuda 500 lt	1800	1500
DISHWASHERS			
41	Perilica posuđa s napom	900	800
42	Perilica posuđa	1350	1100

Determining extracted air flow rates

There are different ways to calculate the air flow rate extracted by a hood for big kitchens:

1. ACCORDING TO THE TYPE OF APPLIANCES

By choosing this method we have to sum the value of the maximum air flow rate to extract in mc/h, issued by each single machine for this reason please see the following table that gives such values.

TABELLA VALORI PORTATE D'ARIA MASSIME EMESSE IN MC/H:

Pos.	Type of appliance	GAS m3/h	EL. m3/h
SERIE 700			
1	Fryer	1600	1300
2	Fry top	1600	1300
3	4 Rings	650	500
4	Bain Marie	250	200
5	Brazier	1000	800
6	Allplate	400	300
7	Round saucepan 40-60 lt	1500	1200
8	Lavastone grill	1750	1350
9	Salamander	-	200
SERIE 900			
10	Fryer	2000	1600
11	Fry top	2000	1600
12	4 Rings	800	650
13	Bain Marie	300	200
14	Brazier	1200	1000
15	Allplate	500	400
16	Square saucepan 100 lt	1800	1400
17	Round saucepan 150-200 lt	2000	1600
18	Lavastone grill	2200	1800
19	6 Rings or 6 Plates	1200	1000
20	8 Rings or 8 Plates	1600	1300
21	Pasta cooker	700	600
ISIAND SERIES			
22	4 Rings	900	800
23	6 Rings	1350	1100
24	8 Rings	1800	1500

Pos.	Type of appliance	GAS m3/h	EL. m3/h
OVENS			
25	Conventional oven with 4 grids	1600	1300
26	Conventional oven with 6 grids	1600	1300
27	Conventional oven with 10 grids	650	500
28	Conventional oven with 20 grids	250	200
29	Conventional steam oven with 4 grids	1000	800
30	Conventional steam oven with 10 grids	400	300
31	Conventional steam oven with 20 grids	1500	1200
AUTOMATIC PASTA COOKERS			
32	Automatic pasta cooker	2000	1600
VARIOUS			
33	Turnable fryer	900	800
34	Automatic brazier	1350	1100
35	Split	1800	1500
36	Large hotplate	1800	1500
SAUCEPANS			
37	Round pan 100 lt	900	800
38	Round pan 200 lt	1350	1100
39	Round pan 300 lt	1800	1500
40	Round pan 500 lt	1800	1500
DISHWASHERS			
41	Hood type dishwasher	900	800
42	Pan washer	1350	1100

PRIRUČNIK ZA ASPIRACIJU

Aspiration manual

SUVREMENOST

VRSTE KORISNIKA	K
Bolnice	1
Kantine	1
Centri za kuhanje	1
Restorani	1
Hoteli i pansioni	0,85
Vjerske ustanove ili vrtići	0,60
Polu moduli	0,50

Nakon što se zbroje sve brzine protoka zraka u odnosu na korištene strojeve, pomnožite zbroj s koeficijentom istovremenosti danim u tablici.

2. S OBZIROM NA „RAVNU“ POVRŠINU NAPE

Izračunali ste područje definirano perimetrom nape (u kvadratnim metrima), bez obzira na vrstu, i množenjem dobivene vrijednosti s koeficijentom koji je ekvivalentan približno 1.100 mc/h (jednako brzini od oko 0,3 m /sek na napi), rezultat će biti prilično opća brzina protoka zraka u mc/h, ali dovoljno pouzdana da vam pomogne vidjeti vrstu strojeva za ekstrakciju koja je potrebna.

Primjer: Napa KPR 12/30 $Q_a = 1,2 \times 3,0 \times 1100 = 3960$ mc/h

3. PREMA VOLUMENU PROSTORIJE

Ako se odlučite za ovu metodu, sve što trebate učiniti je izračunati protok odsisa množenjem vrijednosti satne izmjene zraka navedene u priloženoj tablici s volumenom prostorije.

SOBA	Izmjene zraka po satu
Male kuhinje	30-60
Velike kuhinje	15-40
Pripreme	8-15
Pranje suđa	10-20
Pekara	15-25
bar, kafić	10-15
Blagovaonice, restorani, kantine	8-12
Praonice rublja	10-15
Skladište hrane	5-8

Brzina protoka zraka Q_a (mc/h) = volumen prostorije (mc) x promjena po satu

CONTEMPORANEITY

USER TYPES	K
Hospitals	1
Canteens	1
Cooking centers	1
Restaurants	1
Hotels and guest-houses	0,85
Religious institutions or nursery schools	0,60
Half modules	0,50

Once all the air flow rates relative to the machines used have been added together, multiply the sum by the contemporaneity coefficient given in the table.

2. CONSIDERING THE “FLAT” SURFACE OF THE HOOD

Once you have calculated the area defined by the hood perimeter (in square meters), wherever type it may be, and by multiplying the value obtained by a coefficient equivalent to about 1.100 mc/h (equal to a speed of about 0,3 m/sec on board the hood), the result will be a rather general air flow rate in mc/h but reliable enough to help you see the type of extraction machines required.

Example: Hood KPR 12/30 $Q_a = 1,2 \times 3,0 \times 1100 = 3960 \text{ mc/h}$

3. ACCORDING TO THE Vol. OF THE ROOM

By opting for this method, all you have to do is calculate the extraction flow rate multiplying the hourly air change value given in the enclosed table by the Vol. of the room.

ROOM	Hourly air changes
Small kitchens	30-60
Big kitchens	15-40
Preparations	8-15
Dish washing	10-20
Bakery	15-25
Bar, cafe	10-15
Dining-rooms, restaurants, canteens	8-12
Laundries	10-15
Food warehouse	5-8

Air flow rate $Q_a \text{ (mc/h)} = \text{room Vol. (mc)} \times \text{hourly change}$

PRIRUČNIK ZA ASPIRACIJU

Aspiration manual

4. PREMA RAZMATRANJIMA O UČINKOVITOSTI FILTRIRANJA

Drugi način izračuna protoka temelji se na podacima o maksimalnoj učinkovitosti filtriranja filtara nape. Sve što trebate učiniti je pomnožiti preporučenu vrijednost idealnog prolaza zraka s brojem filtara kako biste pronašli volumen zraka za ispuštanje. Možda ćete morati povećati ili smanjiti broj filtara kako biste održali visoku učinkovitost odvajanja masnih čestica.

Ovdje su navedene vrijednosti preporučene za naše filtre.

Labyrinth filter 400x400		
Min eff. 350 mc/h	Max eff. 450 mc/h	each
Filtro labirinto 400x500		
Min eff. 450 mc/h	Max eff. 550 mc/h	each
Filtro labirinto 500x500		
Min eff. 500 mc/h	Max eff. 600 mc/h	each

Određivanje protoka ulaza, reintegracije i zahvata

Reintegrirani zrak stvaraju ventilatori i uvijek se mora odvoditi u slučaju napa s ulazom. Očito je da to košta više, ali dodatni trošak će biti apsorbiran onim što uštedite na grijanju s ovim proizvodima.

1. REINTEGRACIJA U NAPU SA NETRETIRANIM ZRAKOM

Vrijednost protoka ulaznog zraka (samo na ulaznim i kompenzacijskim napama) s ponovnom integracijom u napu, ekvivalentna je približno 50-60% volumena izvučenog zraka.

Primjer:

ako je Q_a (izvučeni zrak) = 5000 mc/h

Q_i (ulazni zrak) = 50-60% Q_a = 2500-3000 mc/h

2. REINTEGRACIJA U SOBI S TRETIRANIM ZRAKOM

Distribucija obrađenog zraka (samo na kompenzacijskim napama) je kroz rešetke s kopcima što znači da se protok u prostoriju može regulirati; iznosi oko 25% ekstrahiranog zraka.

Primjer:

ako je Q_a (izvučeni zrak) = 5.000 mc/h

Q_c (zrak reintegriran u prostoriju) = 1,250 mc/h

4. ACCORDING TO CONSIDERATIONS ON FILTERING EFFICIENCY

Another way to calculate the flow rate is based on the maximum filtering efficiency data of hood filters. All you have to do is multiply the value of the ideal passage of air recommended by the number of filters to find the Vol. of air to extract. You might have to increase or reduce the number of filters to maintain a high separation efficiency off the oily particles.

The values recommended for our filters are given here.

Labyrinth filter 400x400		
Min eff. 350 mc/h	Max eff. 450 mc/h	each
Labyrinth filter 400x500		
Min eff. 450 mc/h	Max eff. 550 mc/h	each
Labyrinth filter 500x500		
Min eff. 500 mc/h	Max eff. 600 mc/h	each

Determining the input, reintegration and capture flow rate

The reintegrated air is generated by fans and must always be ducted in the case of hoods with input. It is obvious that this costs more but the extra cost will be absorbed by what you save on heating with these products.

1. REINTEGRATION IN THE HOOD WITH UNTREATED AIR

The value of the input air flow rate (only on input and compensation hoods) with reintegration in the hood, is equivalent to approximately 50-60% of the Vol. of extracted air.

Example:

if Q_a (extracted air) = 5000 mc/h

Q_i (input air) = 50-60% Q_a = 2500-3000 mc/h

2. REINTEGRATION IN THE ROOM WITH TREATED AIR

The distribution of treated air (only on compensation hoods) is by through shuttered grilles which means the flow into the room can be regulated; it amounts to about 25% of the extracted air.

Example:

if Q_a (extracted air) = 5.000 mc/h

Q_c (air reintegrated in the room) = 1.250 mc/h

PRIRUČNIK ZA ASPIRACIJU

Aspiration manual

Dimenzioniranje kanala

Zarobljeni zrak uvijek se šalje van ekstrakcijom ili unutra ponovnom integracijom kroz kanale. Na veličinu ovih kanala utječe brzina protoka jer zrak koji struji kroz njih ne smije stvarati preveliku buku niti stvarati velike padove tlaka zbog kojih bi bilo nužno odabrati snažnije, a samim time i ekspanzivnije odsisnike. U pravilu se veličina kanala i plenuma izračunava uzimajući u obzir maksimalnu unutarnju brzinu zraka od oko 7 m/s.

Stoga je očito da se kanali mogu izraditi u različitim veličinama s istom brzinom protoka (različitim brzinama); s obzirom na činjenicu da obično cijena kanala ovisi o težini, razumno je sumnjati u cijene kanala ako su prilično niske (kanali premalih dimenzija = veća brzina zraka = više buke = veći padovi tlaka).

Točna veličina kanala utvrđuje se prema sljedećoj formuli:

$$Q = S \times V \text{ (x 3600)}$$

Gdje je Q = brzina protoka zraka u mc/h

S = dionica prolaza u m²

V = brzina u m/sek

Odakle dobivamo

$$S = Q/V \times 3600 \text{ and } V = Q/S \times 3600$$

Određivanje pada tlaka

Uvijek je potrebno pronaći približnu vrijednost pada tlaka u sustavu. Ovdje nećemo govoriti o točnim metodama proračuna koje podrazumijevaju pozivanje na odgovarajuće tablice i grafikone, ali možemo reći da se padovi tlaka dijele na:

1. LINEARNI PADOVI TLAKA

Zbog otpora izazvanog trenjem na stijenkama kanala koji se suprotstavlja kretanju zraka, a takvi padovi ovise o agregatnom stanju strujanja, brzini zraka te o veličini, hrapavosti i duljini kanala. Možemo otprilike reći da:

- za čelične kanale = 1,5 Pa po dužnom metru kanala
- za zidane kanale = 2,5 Pa dužni metar kanala

2. LOKALIZIRANI PADI TLAKA

Do njih dolazi kada je protok zraka podložen promjenama u smjeru ili veličini (zavoji, grane, prepreke itd.). Možemo reći, otprilike, da:

- | | | |
|--|---|-------------------------------|
| - nape u ekstrakciji = 130-150 Pa | - priključak na jedinicu za ekstrakciju = 50 Pa | - 3-smjerni spoj = 30 Pa |
| - podešavanje zasuna otvorenih 50% = 50 Pa | - plenum = 50 Pa | - istiskivanje zavoja = 35 Pa |
| - protupožarni kapci otvoreni = 20 Pa | - 90° zavoj = 25 Pa | - ravno izbacivanje = 10 Pa |
| - rešetke za dovod zraka = 35 Pa | - 45° zavoj = 10 Pa | - vertikalni izgon = 50 Pa |
| - isporučni otvori = 15 Pa | - kretanje = 30 Pa | |
| - istiskivanje gravitacijom = 20 Pa | - promjena presjeka = 10 Pa | |

Imajte na umu da se padovi tlaka izražavaju u milimetrima vodenog stupca (mm/H₂O) ili u paskalima (Pa).
Imajte na umu da je 1 mm/H₂O = 9,8 Pa

Duct sizing

The captured air is always sent outside by extraction or inside by reintegration through ducts. The size of these ducts is influenced by the rate of flow because the air flowing through them must not make too much noise and neither must it create high drops in pressure which would make it compulsory to choose more powerful, and hence more expansive extractors. As a rule the size of the ducts and plenum are calculated taking into consideration a maximum internal air speed of about 7 m/sec.

It is, therefore, obvious that ducts can be made in different size with the same rate of flow (different speeds); considering the fact that usually the cost of ducts goes by weight then it is reasonable to doubt duct prices if they are rather low (undersized ducts = higher air speed = more noise = higher drops in pressure).

Correct duct size is established using the following formula:

$$Q = S \times V \times 3600$$

Where Q = air flow rate in mc/h

S = passage section in m²

V = speed in m/sec

From where we obtain

$$S = Q/V \times 3600 \text{ and } V = Q/S \times 3600$$

Determining the drop in pressure

It is always necessary to find the approximate value of the system's drop in pressure. We are not going to talk about accurate calculating methods here that entail referring to appropriate tables and graphs but we can say is that pressure drops are divided into:

1. LINEAR PRESSURE DROPS

Due to the resistance caused by friction on the walls of the duct which opposes the movement of air, and such drops depend on the physical state of the flow, the speed of the air and on the size, roughness and length of the duct. We can state approximately, that:

- for steel ducts = 1,5 Pa per linear meter of duct
- for masonry ducts = 2,5 Pa linear meter of duct

2. LOCALIZED PRESSURE DROPS

These occur when the flow of air is subject to changes in direction or magnitude (bends, branches, obstacles, etc.). We can state, approximately, that:

- | | | |
|---------------------------------------|--|------------------------------|
| - hoods in extraction = 130-150 Pa | - fitting on the extraction unit = 50 Pa | - 3-way fitting = 30 Pa |
| - adjusting shutters open 50% = 50 Pa | - plenum = 50 Pa | - bend expulsion = 35 Pa |
| - fire stop shutters open = 20 Pa | - 90° bend = 25 Pa | - straight expulsion = 10 Pa |
| - air intake grids = 35 Pa | - 45° bend = 10 Pa | - vertical expulsion = 50 Pa |
| - delivery vents = 15 Pa | - movement = 30 Pa | |
| - expulsion by gravity = 20 Pa | - section change = 10 Pa | |

Please note that pressure drops are expressed in millimeters of water column (mm/H₂O) or in Pascal (Pa).
Note that 1 mm/H₂O = 9,8 Pa

PRIRUČNIK ZA ASPIRACIJU

Aspiration Manual

Odabir navijača

Nakon što ste odredili protoke sustava i padove tlaka, tada možete odabrati ekstraktor i, ako želite, najprikladniji ventilator imajući na umu sljedeće:

- brzina protoka se ne može dati bez da se odnosi na određeni tlak, i obrnuto.
- također morate imati na umu da se sve potrebne izmjene uvijek mogu napraviti tijekom instalacije kako bi se bolje prilagodilo ono što je definirano kao, na primjer, mijenjanje omjera brzine.
- također imajte na umu da su obično ventilatori instalirani unutar odsisnih i ulaznih jedinica tipa “dvostrukog odsisa”, što znači da se zrak treba odvoditi s obje strane ventilatora, čime se jamči rad i ispravna ravnoteža samog ventilatora. U tu svrhu spojni kanal plašta mora biti okomit na os ventilatora, a također morate uzeti u obzir smjer u kojem se ventilator okreće prilikom postavljanja zavoja, ako je potrebno, nakon ventilatora.

Buka

Ograničenje buke uzrokovane kretanjem zraka vrlo je važno jer poboljšava uvjete rada u kuhinji. Da bismo to učinili, moramo zapamtiti sljedeće:

- svi strojevi ugrađeni u kuhinji pomažu podići razinu buke pa to treba imati na umu kada postavljate nape s ugrađenim ventilatorom ili ako želite postaviti odsisnu ili ulaznu jedinicu unutar nape.
- Nije potrebno spominjati da kanali odgovarajuće veličine također pomažu u smanjenju buke.
- u određenim slučajevima mogu se ugraditi “prigušivači” koji će – ako se biraju prema kriterijima – znatno smanjiti buku.

Choosing the fans

Once you have determined the system's flow rates and pressure drops you can then choose the extractor and, if wanted, the most suitable fan remembering that:

- a flow rate cannot be given without referring it to a certain pressure, and vice versa.
- you must also remember that any necessary alterations can always be made during installation to better adapt what has been defined like, for instance, varying the velocity ratio.
- also keep in mind that normally fans installed inside extraction and input units are the "dual extraction" type which means air needs to be extracted from both sides of the fan thus guaranteeing the performance and correct balance of the fan itself. For this purpose the shroud connecting duct has to be orthogonal to the fan axis and you also have to take into account the direction in which the fan turns when positioning a bend, if needed, after the fan. See also page 40 "how to choose an extraction or input unit".

Noise

Limiting the noise caused by the movement of air is very important as it improves working conditions in the kitchen. To do this we must remember that:

- all the machines installed inside the kitchen help to raise the level of noise so this should be kept in mind when installing hoods with a built-in fan (Ventil series) or if you want to position an extraction or input unit inside the hood.
- it goes without saying that correctly sized ducts help to keep noise down too.
- "silencers" can be installed in certain cases that will – if chosen with criteria – lower noise considerably.

OPĆI UVJETI NABAVE

General Terms of Supply

Podrazumijeva se da su sljedeći uvjeti prodaje i isporuke u potpunosti prihvaćeni bez rezerve uz dodjelu narudžbe i poništavaju sve prethodne.

1. Podaci prikazani u katalogu, ilustracije i crteži su indikativni i ne obvezuju građevinsku tvrtku na vjerno izvođenje detalja. Također zadržavamo pravo na izmjene modela koje sugeriraju iskustvo i tehnički napredak.
2. Nikakve promjene ili modifikacije se ne dogovaraju kada su radovi već započeti.
3. Sve narudžbe se smatraju odobrenima s klauzulom "osim ako ih ne odobri Dom" i naše ponude su neobvezujuće i osim za prodaju.
4. Naše cijene podložne su promjenama u bilo kojem trenutku bez ikakve prethodne obavijesti kao rezultat povećanja troškova sirovina, rada i bilo čega drugog što spada u proizvodni ciklus robe i ni u kojem slučaju nisu obvezujuće bez potvrde narudžbe od strane Vidovic.
5. Zahtjevi za očite nedostatke kupljenog materijala, koji naravno ne ovise o transportu, ili za neusklađenost s poslanom narudžbom, moraju se podnijeti u roku od osam dana od primitka robe preporučenim pismom ili e-mailom. Nakon tog roka reklamacija više nema. Materijali koji se smatraju neispravnim moraju se, nakon našeg odobrenja, vratiti u naša skladišta.
6. Roba je uvijek namijenjena za isporuku franko tvornica. Ako je, za posebne dogovore, isporuka uspostavljena besplatno na određitu, podrazumijeva se da se u svakom slučaju isporučuje na kamionu koji nije istovaren, stoga troškovi i rizici vezani uz istovar ostaju na trošku kupca. Roba, čak i ako je prodana plaćeni prijevoz, uvijek putuje u ime i rizik kupca koji ima dužnost provjeriti robu u trenutku isporuke kako bi provjerio eventualna oštećenja robe tijekom prijevoza. U slučaju oštećenja ili nestanka artikala, dužnost kupca je dostaviti prijevozniku, u trenutku isporuke, odgovarajuće oznake na istoj otpremnici. Nedostatak rezerve na dostavnici potvrđuje da roba ne predstavlja nikakav problem i kupac ne može pristupiti nikakvoj naknadi osiguranja.
7. Palete zadužene na fakturi mogu se vratiti na zahtjev odobren faksom. Pobrinut ćemo se da ih preuzme naš kurir nakon isporuke sljedeće narudžbe vašoj tvrtki i bit će izdano odobrenje.
8. Troškovi prijevoza će biti dogovoreni s vremena na vrijeme u trenutku narudžbe na temelju udaljenosti i iznosa narudžbe.
9. U slučaju oštećenja ili nestanka artikala, dužnost kupca je dostaviti prijevozniku, u trenutku isporuke, odgovarajuće rezervacije na istoj otpremnici.
10. Ako se rok isporuke iz bilo kojeg razloga ne poštuje bez obzira na volju ALUMINOX SRL, Kupac neće imati pravo zahtijevati bilo kakvu kompenzaciju, otkazivanje ili promjenu dane narudžbe.
11. U slučaju neusklađenosti kupca s bilo kojim od njegovih uvjeta pošte i, posebno, u bilo kojem slučaju kašnjenja ili potpunog ili djelomičnog neplaćanja dospjelih iznosa, prodavatelj zadržava pravni postupak i može odgoditi prodaju ugovor ima potpuno pravo na potpuno izuzeće od bilo koje druge isporuke po trošku. Eventualni sporovi ne daju korisniku pravo na odgodu plaćanja.
12. Vraćena roba, samo u iznimnim slučajevima i podliježe našem posebnom odobrenju, mora spriječiti plaćeni prijevoz, a da nije korištena i u savršenom stanju.
13. U slučaju prodaje izvan teritorija Hrvatske, mjerodavno pravo za ugovor je hrvatsko pravo. Za svaki pravni spor izričito je dogovorena isključiva nadležnost suda u Zagrebu.
14. Produljenje jamstva je dvije godine od datuma prodaje.

Pažnja: što učiniti prije potpisivanja prijevoznog dokumenta DDT.

1. Provjerite broj primljenih paketa: mora biti isti kao onaj označen na DDT-u (ili dostavnici).
2. Provjerite naljepnice nalijepljene na pakete: moraju imati točnu adresu.
3. Provjerite vanjsko stanje paketa: ne smiju biti oštećeni ili neovlašteno mijenjani.
4. U slučaju anomalije: potpisati dostavnicu (ili dostavnicu kurirske službe) uz oznaku REZERVA i navesti vrstu utvrđene anomalije (primjerice: rezerva za pakete koji nedostaju; rezerva za paket s oštećenim ili oštećenim kartonom i sl.).
5. Stavljanje pričuve pravo je sankcionirano građanskim zakonikom (čl. 1968.). Imajte na umu da generičke rezervacije više nemaju pravnu vrijednost (primjer: prihvaćate s predmetom kontrole itd.).

Stoga je ključno izvršiti analizu, kao što je gore opisano, u prisutnosti kurira, navodeći razloge za sve rezervacije.

The following conditions of sale and delivery are understood to be fully accepted without reserve with the conferment of the order and cancel all the previous ones.

1. The data shown in the catalog, the illustrations and the drawings are indicative and do not bind the construction company to a faithful execution of the details. The faculty to make changes to the models that the experience and technical advances suggest is also reserved.
2. No changes or modifications are agreed upon when work has already begun.
3. All orders are considered as granted with the clause "unless approved by the House" and our offers are without obligation and except for the sold.
4. Our prices are subject to change at any time without any prior notice as a result of increases in the cost of raw materials, labor and anything else falling within the production cycle of the goods and in any case are not binding without confirmation of order by Vidovic.
5. Claims for apparent defects of the purchased material, naturally not dependent on transport, or for non-compliance with the order sent, must be made within eight days of receipt of the goods by registered letter or fax (in this case exclusively using the form). After this deadline, complaints will no longer be accepted. The materials considered defective must, after our authorization, be returned to our warehouses in free port. (Exclusively using the appropriate form which will be countersigned for acceptance and must be attached to the DDT).
6. The goods are always intended to be delivered ex-works. If, for special agreements, delivery is established free at destination, it is understood in any case rendered on a truck that is not unloaded, therefore charges and risks related to discharge remain at the customer's expense. The goods even if sold carriage paid, always travel on behalf and risk of the customer who has the duty to check the goods at the time of delivery to verify any damage suffered by the goods during transport. In the event of damage or missing items, it is the purchaser's duty to forward to the carrier, at the time of delivery, the appropriate reservations on the same delivery note. The lack of reserve on the delivery note attests that the goods do not present any problem and the customer cannot access any insurance reimbursement.
7. The pallets debited on the invoice can be returned upon request authorized by fax. We will take care to have them picked up by our courier upon delivery of the next order to your company and a credit note will be issued.
8. The transport costs will be agreed from time to time at the time of the order based on the distance and the amount of the order.
9. In the event of damage or missing items, it is the purchaser's duty to forward to the carrier, at the time of delivery, the appropriate reservations on the same delivery note.
10. If the delivery term should not be respected for any reason regardless of the will of Vidovic, the Customer will not be entitled to demand any compensation, cancellation or changes to the order given.
11. In the event of non-compliance by the customer with any of its post conditions and, in particular, in any case of delay or total or partial non-payment of the sums due, the seller reserves legal action and may defer the sales contract is fully entitled to complete exemption from any other supply at cost. Any disputes do not give the customer any right to defer payments.
12. Returned goods, only in exceptional cases and subject to our specific authorization, must prevent carriage paid, without having been used and in perfect condition.
13. In case of sale outside the Italian territory, the law applicable to the contract is the Italian one. For any legal dispute, the exclusive jurisdiction of the court of Perugia is expressly agreed.
14. The warranty extension is two years from the date of sale.

Attention: what to do before signing the transport document DDT.

1. Check the number of packages received: must be the same as the one marked on the DDT (or courier delivery note).
2. Check the labels affixed to the packages: they must have the correct address.
3. Check the external condition of the packages: they must not present any damage or have been tampered with.
4. In the event of an anomaly: sign the delivery note (or courier delivery note), affixing RESERVE and specifying the type of anomaly found (for example: reserve for missing packages; reserve for package with damaged or damaged cardboard, etc.).
5. To affix the reserve is a right sanctioned by the civil code (Art. 1968). Please note that generic reservations no longer have any legal value (example: you accept with control subject, etc.).

It is therefore essential to make an analysis, as described above, in the presence of the courier, giving reasons for any reservations.

AD·INOX

Ad inox professional d.o.o.
Jazvine 16/b, 49 232 Radoboj
OIB: 29373290902

www.ad-inox.com

